

# Mask with charcoal filter requirement area

< Attachment (1) >  
 February 23, 2012  
 Tokyo Electric Power Company

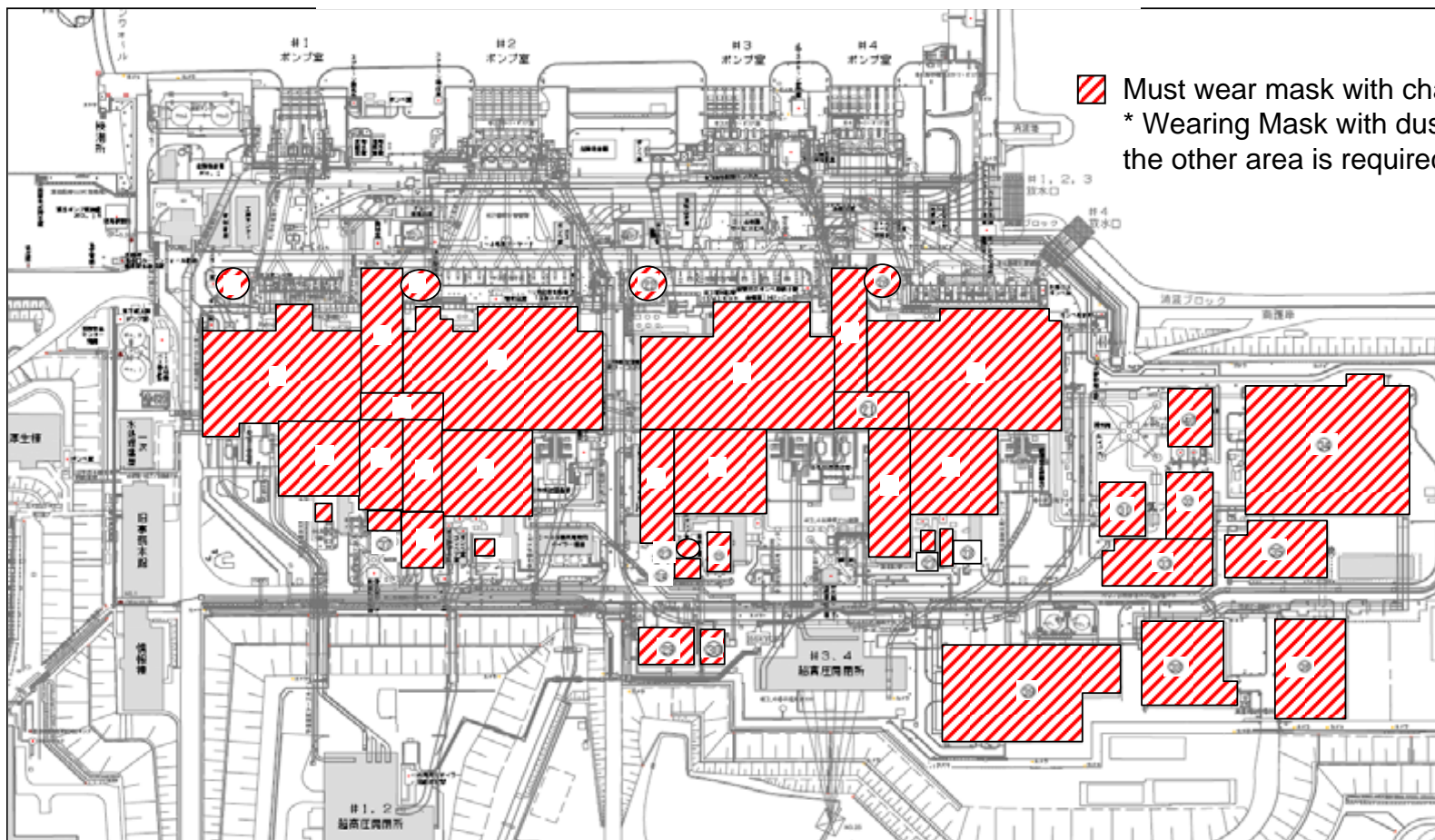

- Unit 1 Reactor building
- Unit 1 Turbine building
- Unit 1 Waste treatment building
- Unit 2 Reactor building
- Unit 2 Turbine building
- Unit 2 Waste treatment building
- Unit 1&2 Service building
- Unit 1&2 Control building
- Unit 1 Condensate storage tank
- Unit 1 Waste liquid storage tank

- Unit 2 Condensate storage tank
- Unit 2 Waste liquid storage tank
- Unit 1&2 FSTR building
- Unit 3 Reactor building
- Unit 3 Turbine building
- Unit 3 Waste treatment building
- Unit 4 Reactor building
- Unit 4 Turbine building
- Unit 4 Waste treatment building
- Unit 3&4 Service building

- ⑳ Unit 3&4 Control building
- ㉑ Unit 3 Condensate storage tank
- ㉒ Unit 3 Waste liquid storage tank
- ㉓ Unit 3 Shower & laundry tank
- ㉔ Unit 3 FSTR building
- ㉕ Unit 4 Condensate storage tank
- ㉖ Unit 4 Waste liquid storage tank
- ㉗ Unit 4 FSTR building
- ㉘ Unit 1&2 activated charcoal holdup equipment building
- ㉙ Unit 3 activated charcoal holdup equipment building

- ㉚ Main exhaust fan building
- ㉛ Combustible miscellaneous solid waste
- ㉜ Incineration workshop building
- ㉝ Centralized waste treatment building
- ㉞ On-site banker building
- ㉟ Unit 1&2 Common suppression pool water surge-tank
- ㊱ Shower drain tank building
- ㊲ Miscellaneous solid waste volume reduction treatment building
- ㊳ Common facility for service
- ㊴ Centralized radiation waste treatment facility building