

Water Stop Work at the Area Water Inflow into Unit 3 Radiation Waste Underground Storage Facility Building was Confirmed at Fukushima Daiichi Nuclear Power Station

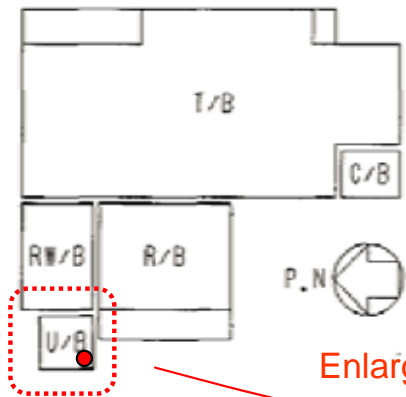

Enlarged

Location of water inflow:
Unit 3 Radiation Waste
Underground Storage Facility
Building (U/B)

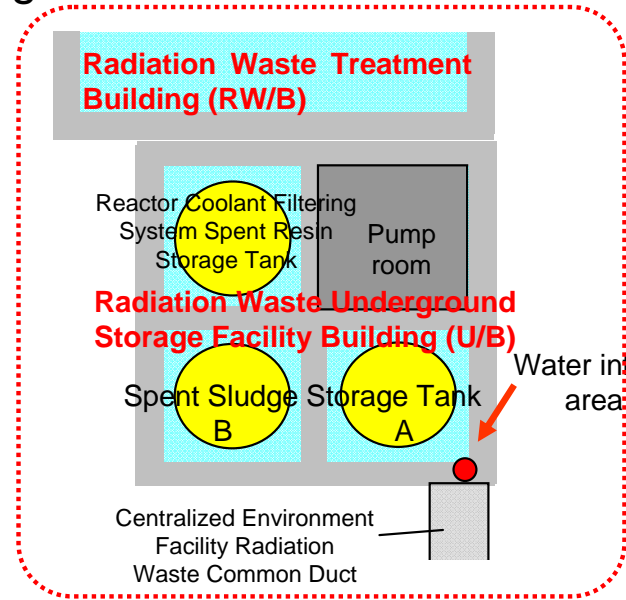

Location where water inflow was confirmed
(Photo taken by a TEPCO employee on May 29)

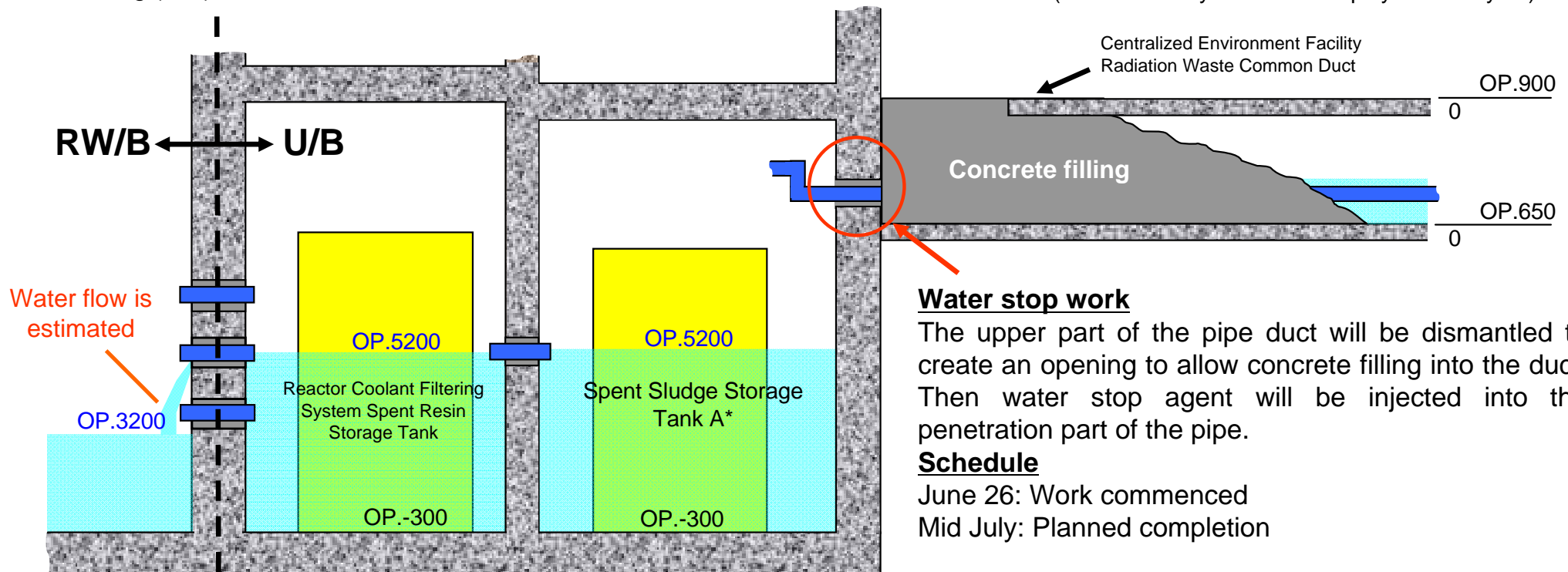

Water stop work

The upper part of the pipe duct will be dismantled to create an opening to allow concrete filling into the duct. Then water stop agent will be injected into the penetration part of the pipe.

Schedule

June 26: Work commenced
Mid July: Planned completion

* Reactor coolant filtering system spent resin storage tank is connected with waste sludge storage tank B side.