

Inspection Status of Trench, etc. at Fukushima Daiichi Nuclear Power Station (Preliminary Result, January 12, 2012)

January 12, 2012
Tokyo Electric Power Company

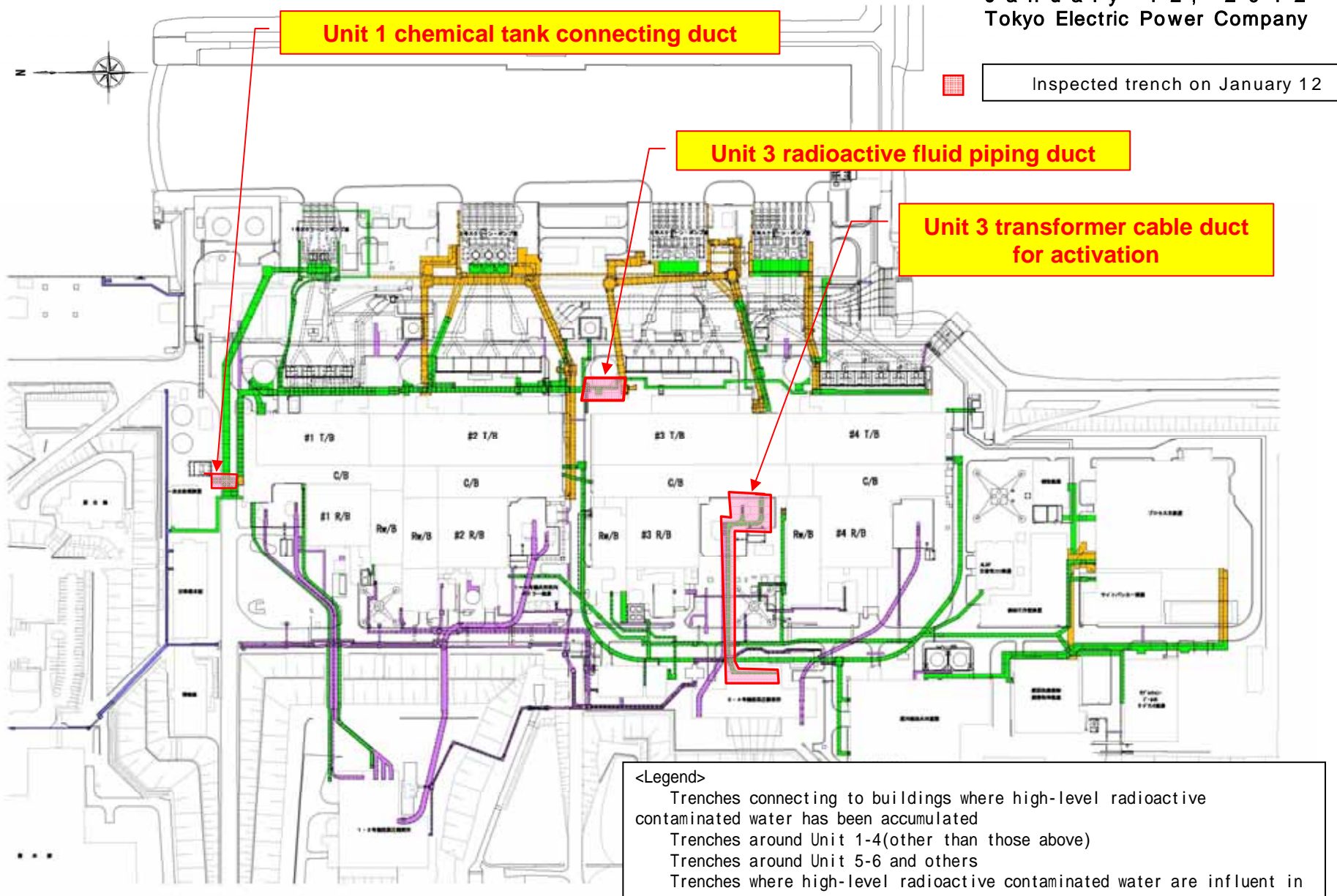

Inspection Status of Trench, etc. at Fukushima Daiichi Nuclear Power Station (Preliminary Result in the Unit 1 Chemical Tank Connecting Duct, January 12, 2012)

January 12, 2012
Tokyo Electric Power Company

【Result】

We found a puddle at today's inspection.

【Date】

At 10:00 am, on January 12, 2012

【Place】

In the Unit 1 chemical tank connecting duct

【Amount of the puddle】

Under evaluation

【Surface dose rate of the container of detected water】

Around 0.0012mSv/h (Around 1.2 μ Sv/h)

【Preliminary Nuclide Analysis Results】

The nuclide analysis results of detected water is as follows.

Nuclide	Radioactivity Concentration (Bq/cm ³)	Measurable Limits (Bq/cm ³)	Half-life
I-131	ND	5.7X10 ⁻²	Around 8 days
Cs-134	2.4X10 ⁰	7.3X10 ⁻²	Around 2 years
Cs-137	3.5X10 ⁰	7.6X10 ⁻²	Around 30 years

Inspection Status of Trench, etc. at Fukushima Daiichi Nuclear Power Station (Preliminary Result in the Unit 3 transformer Cable Duct for activation, January 12, 2012)

January 12, 2012
Tokyo Electric Power Company

【Result】

We found a puddle at today's inspection.

【Date】

At 10:00 am, on January 12, 2012

【Place】

In the Unit 3 transformer cable duct for activation

【Amount of the puddle】

Approx. 300m³

【Surface dose rate of the container of detected water】

Around 0.0016mSv/h (Around 1.6 μ Sv/h)

【Preliminary Nuclide Analysis Results】

The nuclide analysis results of detected water is as follows.

Nuclide	Radioactivity Concentration (Bq/cm ³)	Measurable Limits (Bq/cm ³)	Half-life
I-131	ND	2.3X10 ⁻¹	Around 8 days
Cs-134	4.9X10 ¹	2.1X10 ⁻¹	Around 2 years
Cs-137	6.9X10 ¹	1.9X10 ⁻¹	Around 30 years

Inspection Status of Trench, etc. at Fukushima Daiichi Nuclear Power Station (Preliminary Result in the Unit 3 Radioactive Fluid Piping Duct, January 12, 2012)

J a n u a r y 1 2 , 2 0 1 2
Tokyo Electric Power Company

【Result】

We Confirmed that there is no puddle at today's inspection.

【Date】

At 10:40 am, on January 12, 2012

【Place】

In the Unit 3 radioactive fluid piping duct

Inspection Status View of Trench, etc. at Fukushima Daiichi Nuclear Power Station (Preliminary Result)

J a n u a r y 1 2 , 2 0 1 2
Tokyo Electric Power Company

【Inspection area】

Fukushima Daiichi Nuclear Power Station Unit 1 ~ 4 , trenches etc. connected to the centralized radiation waste treatment facility building

Date of Inspection	Place	Puddle	Surface dose rate	Result of nuclide analysis (Bq/cm ³)		
				I - 1 3 1	C s - 1 3 4	C s - 1 3 7
Jan. 11	Connecting duct of D G Unit 2-4	Discovered	9 μSv/h	ND	1.9 × 10 ⁰	2.6 × 10 ⁰
	Water treatment building connecting duct of T/B Unit 1	Discovered	1.5 μSv/h	ND	8.8 × 10 ⁻¹	1.3 × 10 ⁰