

The seawall area at Fukushima Daiichi NPS

<Reference>
January 8, 2014
Tokyo Electric Power Company

Movement in groundwater level (Between Unit 1 and 2: From Dec. 7 to Jan. 7)

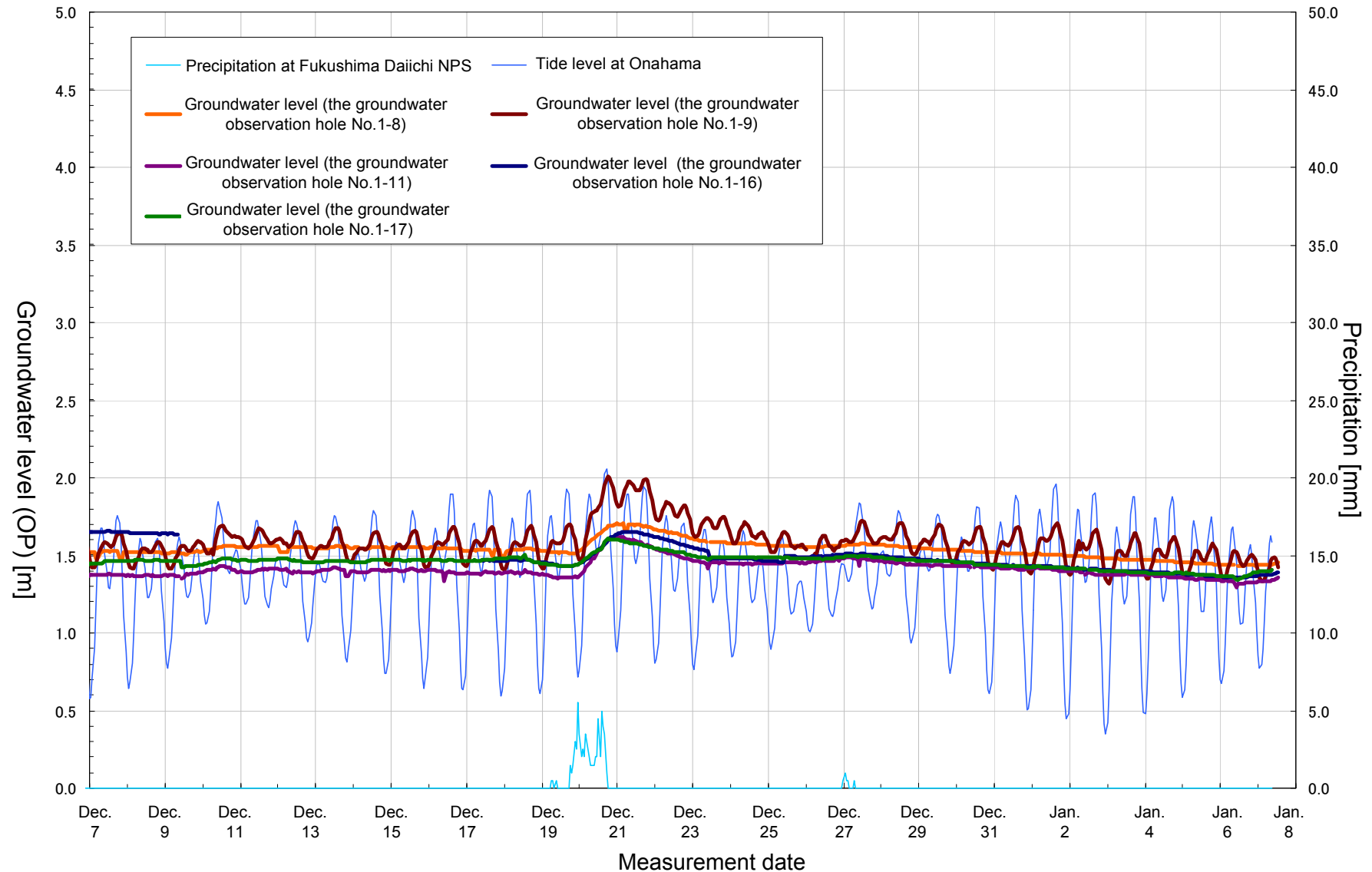

Progress in the ground improvement work between Unit 1 and 2 (As of in the morning on January 8)

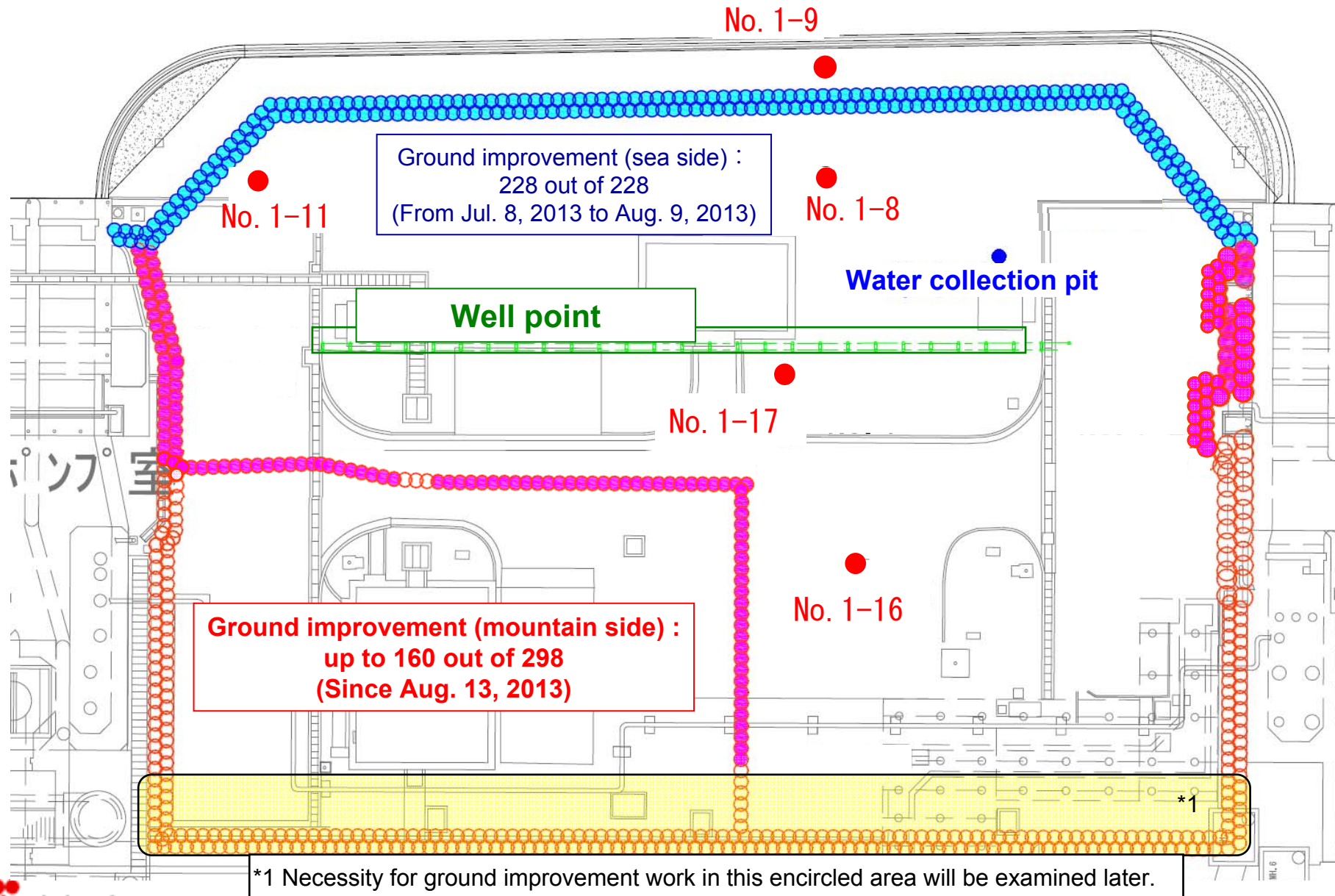

Movement in groundwater level (Between Unit 2 and 3: From Dec. 7 to Jan. 7)

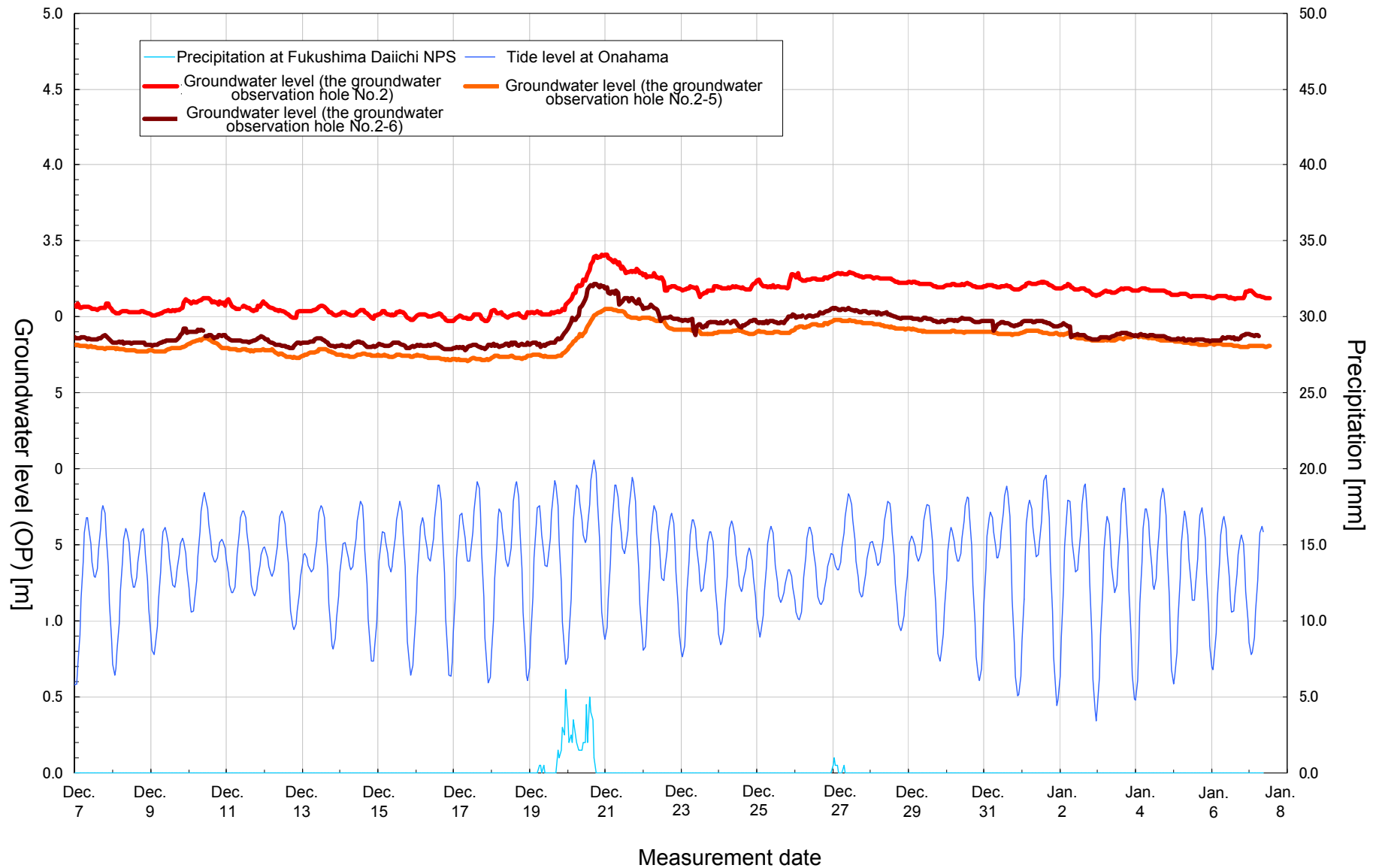

Progress in the ground improvement work between Unit 2 and 3 (As of in the morning on January 8)

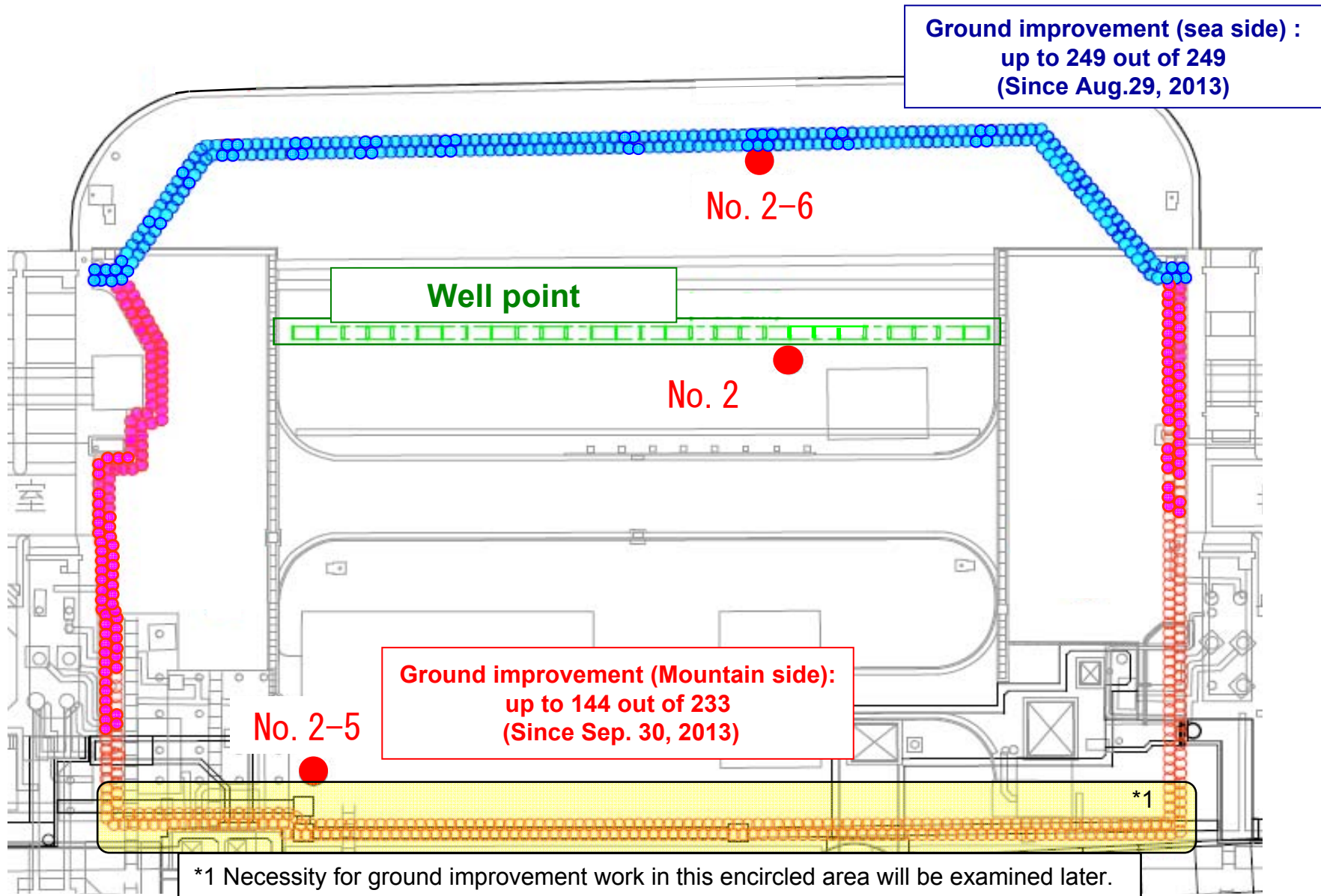

Movement in groundwater level (Between Unit 3 and 4: From Dec. 7 to Jan. 7)

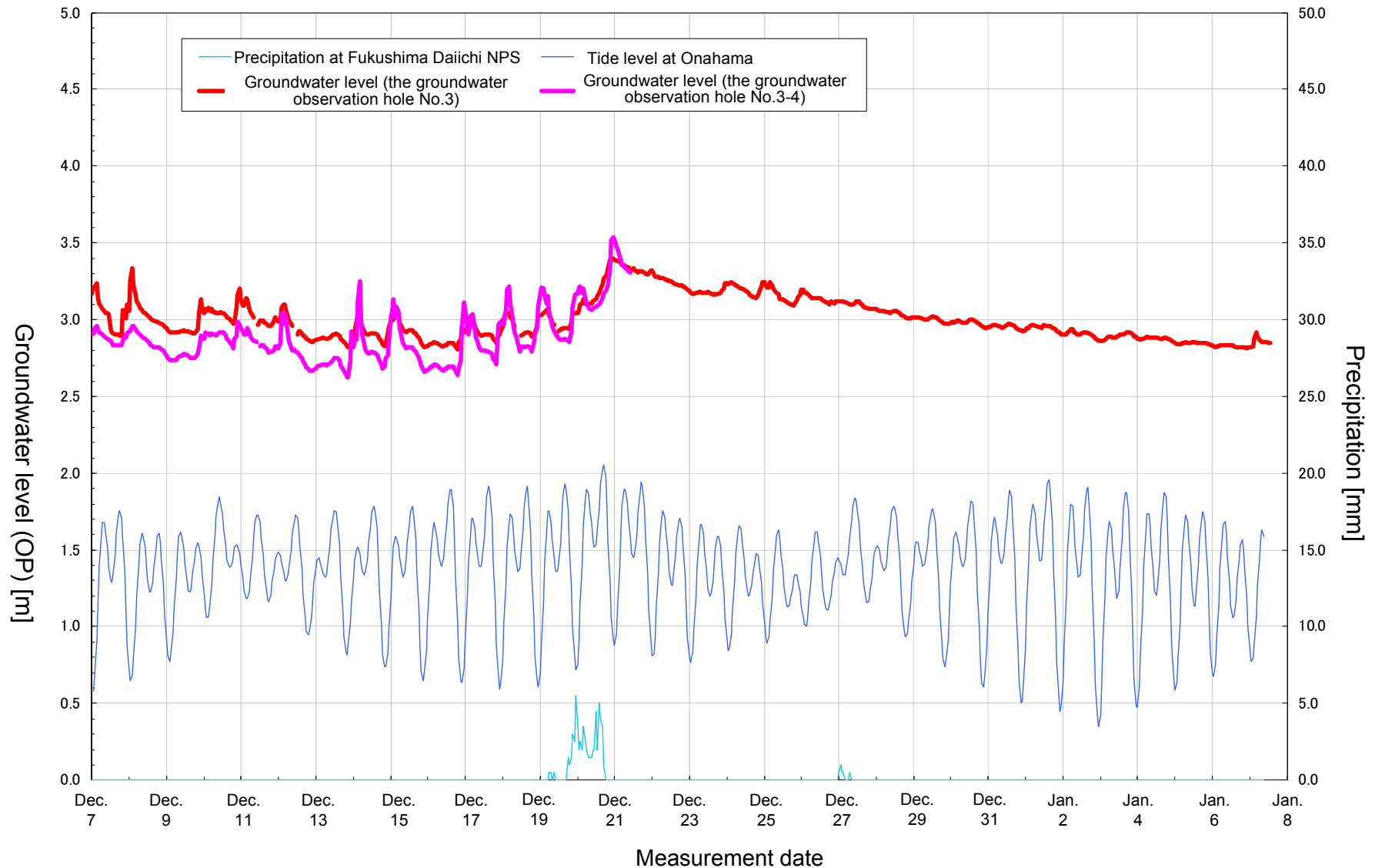

* The water level gauge at the observation hole No.3-4 has been temporarily removed due to the ground improvement work.

Automatic measurement through a water level gauge

Progress in the ground improvement work between Unit 3 and 4 (As of in the morning on January 8)

Ground improvement (sea side):
up to 117 out of 132
(Since Aug. 23, 2013)

Ground improvement (mountain side):
up to 36 out of 273
(Since Oct. 19, 2013)

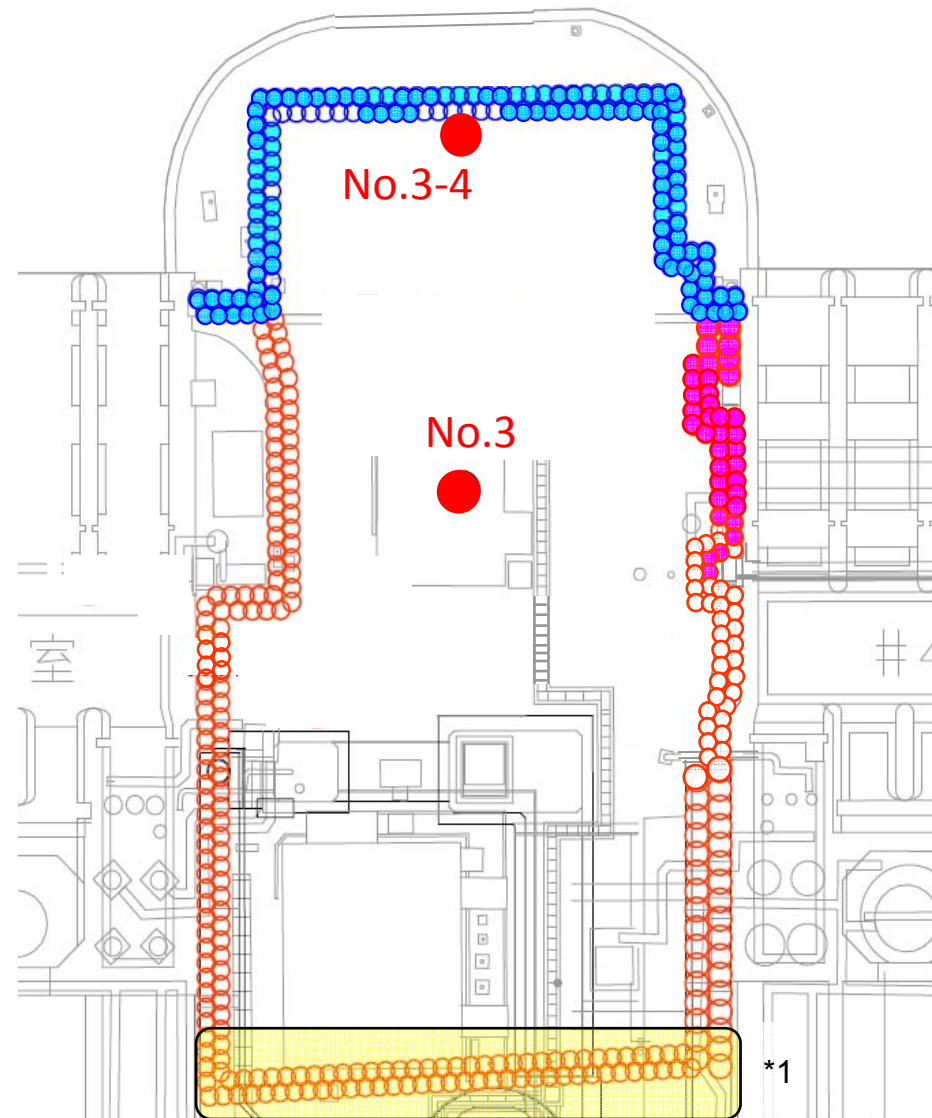

*1 Necessity for ground improvement work in this encircled area will be examined later.