

<Reference>

Historical Data of Radioactive Density in Groundwater at the East Side of Turbine Buildings

December 6, 2013

Tokyo Electric Power Company



東京電力

Progress Status of Ground Improvement Construction between Unit 1 and 2 (As of the Morning on December 6)

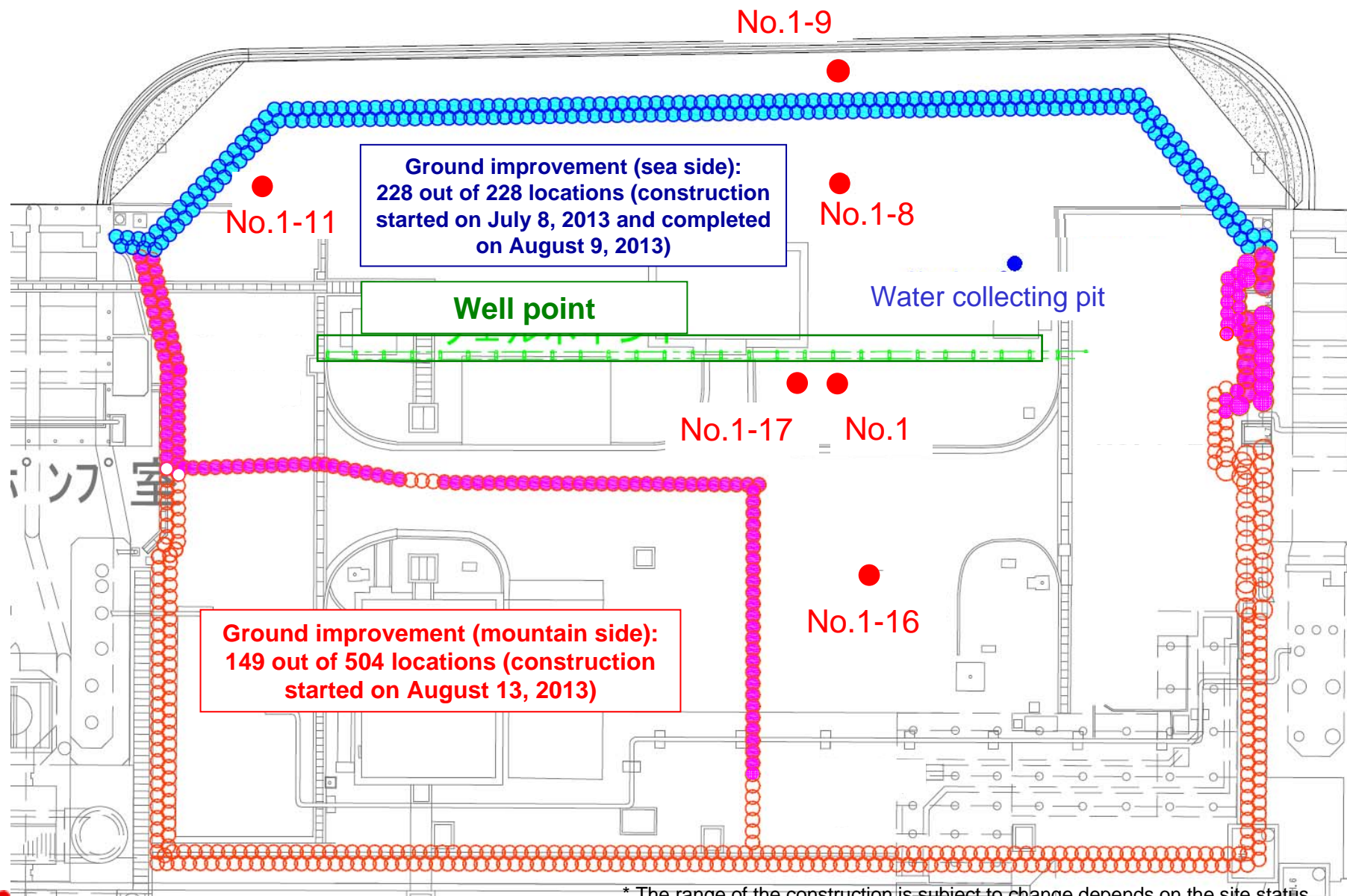

* The range of the construction is subject to change depends on the site status.

Progress Status of Ground Improvement Construction between Unit 2 and 3 (As of the Morning on December 6)

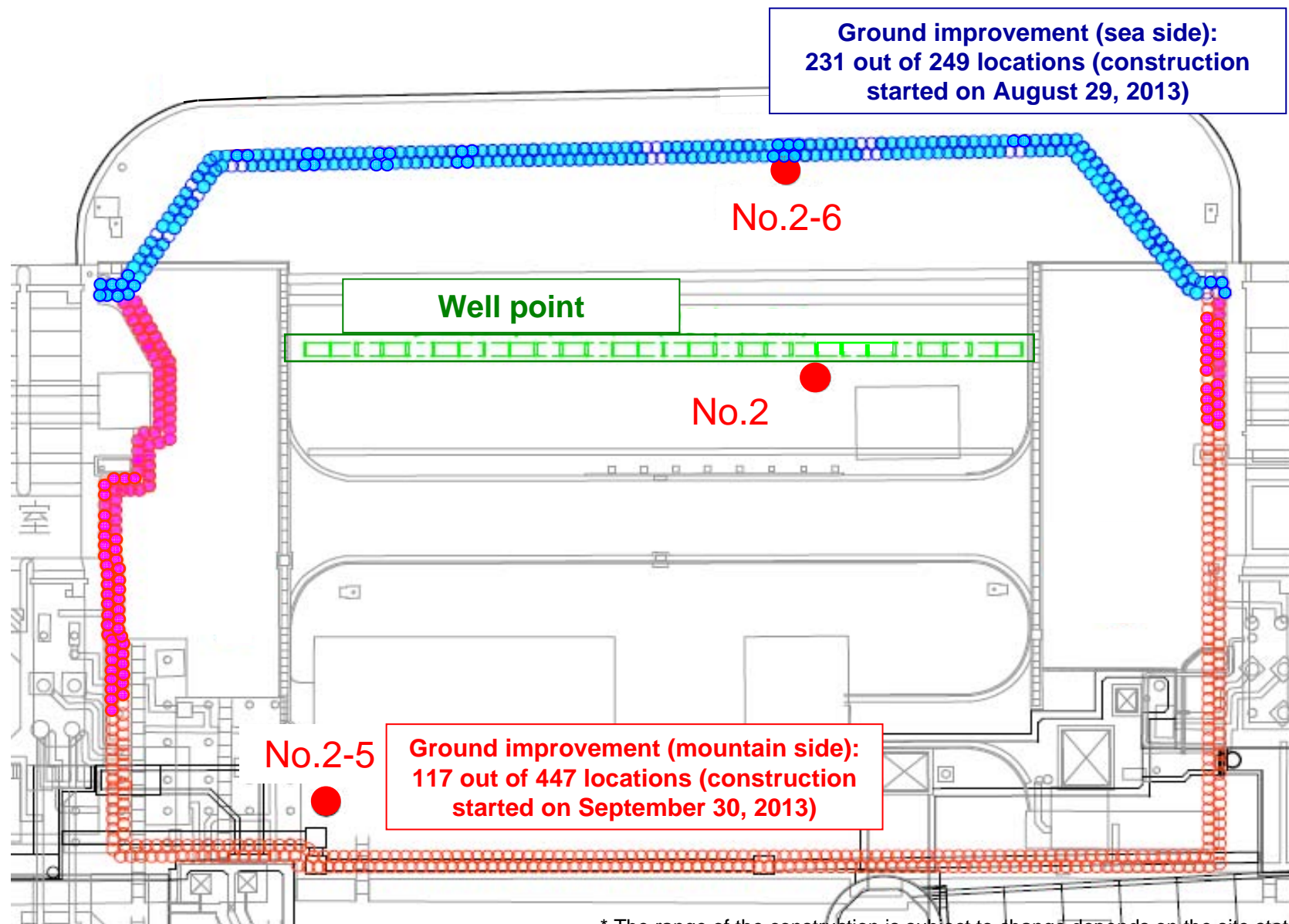

* The range of the construction is subject to change depends on the site status.

Progress Status of Ground Improvement Construction between Unit 3 and 4 (As of the Morning on December 6)

Ground improvement (sea side):
47 out of 132 locations (construction
started on August 23, 2013)

Ground improvement (mountain side):
36 out of 273 locations (construction
started on October 19, 2013)

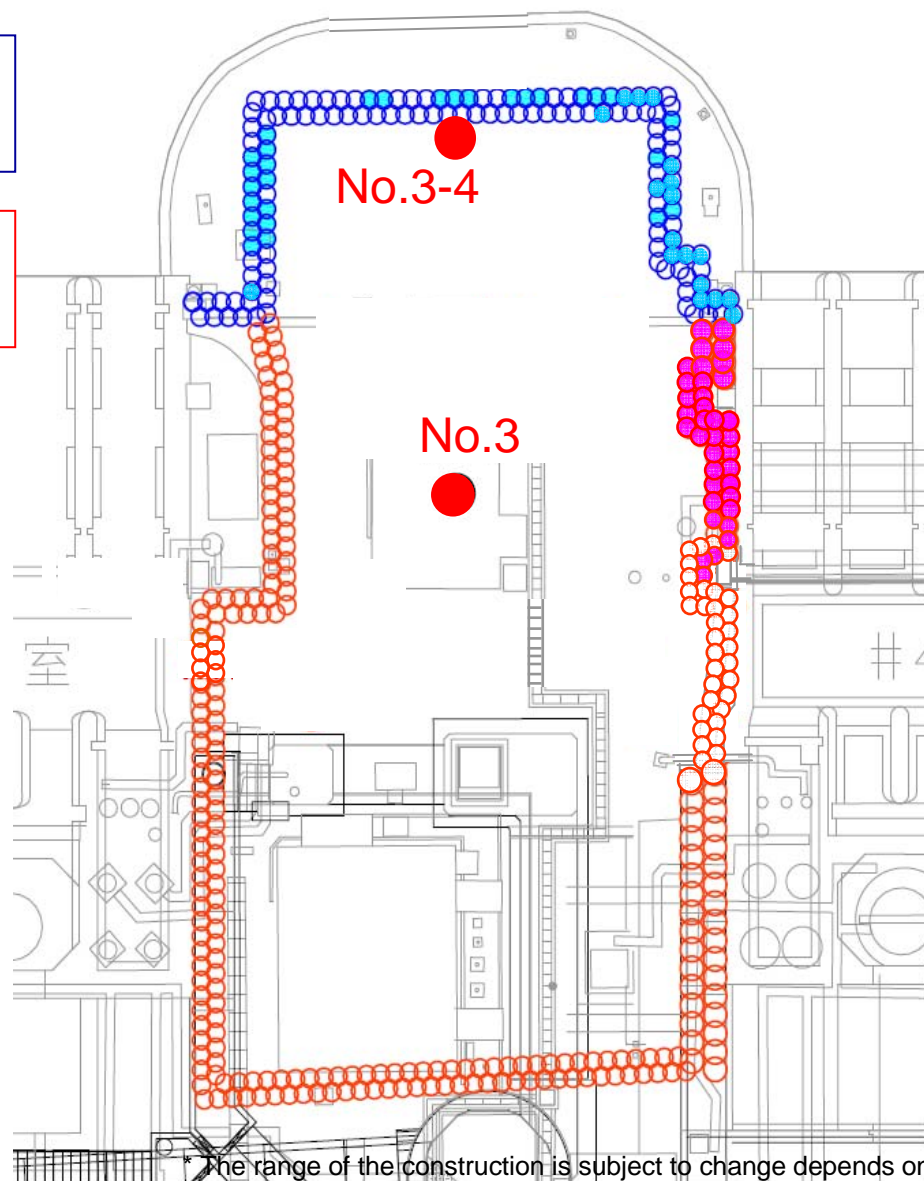

* The range of the construction is subject to change depends on the site status.

Groundwater observation hole No.0-1 (Bq/L)

Sampling date	2013/8/8	2013/8/8 (Remeasurement)	2013/8/10	2013/8/15	2013/8/22	2013/8/29	2013/9/1	2013/9/8	2013/9/15	2013/9/22	2013/9/29	2013/10/6	2013/10/13	2013/10/20	2013/10/27	2013/11/3
Sampling time	2:15 PM	2:15 PM	9:35 AM	10:52 AM	9:41 AM	9:50 AM	11:03 AM	12:02 PM	9:52 AM	10:25 AM	9:54 AM	9:45 AM	9:50 AM	9:37 AM	9:50 AM	9:47 AM
Cs-134	0.61		0.66	0.39	ND (0.42)	1.4	0.80	0.92	1.7	2.1	3.0	2.3	2.9	5.1	2.4	3.5
Cs-137	1.6		1.2	1.1	0.64	3.0	2.1	2.4	4.4	4.6	5.8	5.9	6.7	9.5	5.8	8.8
Ru-106	ND		ND	ND	ND	ND	ND	ND	ND	ND	ND	ND	ND	ND	ND	ND
Mn-54	ND		ND	ND	ND	ND	ND	ND	ND	ND	ND	ND	ND	ND	ND	ND
Co-60	ND		ND	ND	ND	ND	ND	ND	ND	ND	ND	ND	ND	ND	ND	ND
Sb-125	ND		ND	ND	ND	ND	ND	ND	ND	ND	ND	ND	ND	ND	ND	ND
Gross β	210		290	210	300	86	160	79	170	120	170	160	180	130	61	110
H-3	23,000	23,000	34,000	35,000	42,000	45,000	38,000	30,000	20,000	19,000	19,000	16,000	19,000	11,000	8,600	26,000
Sr-90	Under measurement		-	-	-	-	-	-	-	-	-	-	-	-	-	-

* "ND" indicates that the measurement result is below the detection limit, and the detection limit of each nuclide is provided in parentheses.

Groundwater observation hole No.0-1-2 (Bq/L)

Sampling date	2013/11/10	2013/11/17	2013/11/24	2013/12/1
Sampling time	10:04 AM	9:42 AM	9:47 AM	9:47 AM
Cs-134	6.3	5.3	5.9	6.5
Cs-137	14	12	13	16
Ru-106	ND	ND	ND	ND
Mn-54	ND	ND	ND	ND
Co-60	ND	ND	ND	ND
Sb-125	ND	ND	ND	ND
Gross β	80	93	97	89
H-3	31,000	28,000	26,000	Under measurement
Sr-90	-	-	-	-

* "ND" indicates that the measurement result is below the detection limit, and the detection limit of each nuclide is provided in parentheses.

Sampling date	2013/11/10	2013/11/17	2013/11/24	2013/12/1
Sampling time	12:42 PM	10:02 AM	10:11 AM	10:07 AM
Cs-134	ND (0.42)	ND (0.40)	ND (0.37)	ND (0.42)
Cs-137	ND (0.52)	0.51 (0.44)	ND (0.44)	ND (0.46)
Ru-106	ND	ND	ND	ND
Mn-54	ND	ND	ND	ND
Co-60	ND	ND	ND	ND
Sb-125	ND	ND	ND	ND
Gross β	21	ND (18)	ND (21)	ND (17)
H-3	36,000	48,000	64,000	Under measurement
Sr-90	Under measurement	-	-	-

* "ND" indicates that the measurement result is below the detection limit, and the detection limit of each nuclide is provided in parentheses.

Groundwater observation hole No.0-2 (Bq/L)

Sampling date	2013/9/2	2013/9/8	2013/9/15	2013/9/22	2013/9/29	2013/10/6	2013/10/13	2013/10/20	2013/10/27	2013/11/3	2013/11/10	2013/11/17	2013/11/24	2013/12/1
Sampling time	9:51 AM	12:35 PM	10:32 AM	11:15 AM	10:52 AM	11:20 AM	11:08 AM	11:04 AM	10:40 AM	10:37 AM	11:03 AM	10:42 AM	11:47 AM	11:52 AM
Cs-134	ND (0.47)	ND (0.46)	ND (0.42)	ND (0.45)	ND (0.39)	ND (0.34)	0.61 (0.41)	ND (0.41)	ND (0.42)	ND (0.44)	0.46 (0.39)	ND (0.39)	0.59 (0.41)	ND (0.41)
Cs-137	0.75	0.67	0.93	ND (0.55)	ND (0.46)	0.52	1.6	0.76	0.58	0.72	0.80	ND (0.54)	1.4	0.49
Ru-106	ND	ND	ND	ND	ND	ND	ND	ND	ND	ND	ND	ND	ND	ND
Mn-54	ND	ND	ND	ND	ND	ND	ND	ND	ND	ND	ND	ND	ND	ND
Co-60	ND	ND	ND	ND	ND	ND	ND	ND	ND	ND	ND	ND	ND	ND
Sb-125	ND	ND	ND	ND	ND	ND	ND	ND	ND	ND	ND	ND	ND	ND
Gross β	ND (24)	ND (17)	19	37	24	28	87	ND (15)	22	ND (17)	ND (17)	ND (18)	ND (21)	ND (17)
H-3	ND (120)	ND (130)	ND (120)	ND (120)	ND (120)	ND (110)	ND (130)	ND (130)	ND (120)	ND (120)	ND (110)	130	260	Under measurement
Sr-90	Under measurement	-	-	-	-	-	-	-	-	-	-	-	-	-

* "ND" indicates that the measurement result is below the detection limit, and the detection limit of each nuclide is provided in parentheses.

Groundwater observation hole No.0-3-1 (Bq/L)

Sampling date	2013/11/20	2013/11/24	2013/12/1
Sampling time	12:44 PM	11:02 AM	10:37 AM
Cs-134	ND (0.42)	0.44 (0.44)	ND (0.44)
Cs-137	0.86	0.76	0.83
Ru-106	ND	ND	ND
Mn-54	ND	ND	ND
Co-60	ND	ND	ND
Sb-125	ND	ND	ND
Gross β	ND (21)	ND (21)	ND (17)
H-3	ND (120)	ND (120)	Under measurement
Sr-90	Under measurement	-	-

* "ND" indicates that the measurement result is below the detection limit, and the detection limit of each nuclide is provided in parentheses.

Groundwater observation hole No.0-4 (Bq/L)

Sampling date	2013/10/27	2013/11/3	2013/11/10	2013/11/17	2013/11/24	2013/12/1
Sampling time	12:25 PM	12:00 PM	12:10 PM	11:35 AM	12:55 PM	1:08 PM
Cs-134	ND (0.38)	ND (0.41)	ND (0.44)	ND (0.40)	ND (0.37)	ND (0.36)
Cs-137	ND (0.49)	ND (0.53)	0.48	ND (0.52)	ND (0.48)	0.49
Ru-106	ND	ND	ND	ND	ND	ND
Mn-54	ND	ND	ND	ND	ND	ND
Co-60	ND	ND	ND	ND	ND	ND
Sb-125	ND	ND	ND	ND	ND	ND
Gross β	ND (19)	ND (17)	ND (17)	ND (18)	ND (21)	ND (17)
H-3	13,000	17,000	19,000	16,000	15,000	Under measurement
Sr-90	Under measurement	-	-	-	-	-

* "ND" indicates that the measurement result is below the detection limit, and the detection limit of each nuclide is provided in parentheses.

Groundwater observation hole No.1 (Bq/L)

Sampling date	2012/12/8 ¹	2013/5/24	2013/5/31	2013/6/7 (1)	2013/6/7 (2)	2013/6/14 (1)	2013/6/14 (2)	2013/6/21	2013/6/25	2013/6/28	2013/7/1	2013/7/4	2013/7/8	2013/7/11	2013/7/15	2013/7/19
Sampling time	11:00 AM	4:19 PM	3:01 PM	3:45 PM	3:45 PM	2:29 PM	2:29 PM	9:01 AM	1:39 PM	5:50 PM	3:05 PM	11:50 AM	1:30 PM	12:51 PM	1:00 PM	8:02 AM
Cs-134	ND (0.59)	ND (0.45)	0.53	ND (0.42)	ND (0.40)	ND (0.37)	ND (0.37)	ND (0.36)	ND (0.39)	ND (0.40)	1.1	ND (0.64)	ND (0.50)	ND (0.61)	ND (0.43)	ND (0.48)
Cs-137	ND (0.72)	ND (0.45)	0.57	ND (0.53)	0.49	ND (0.43)	0.51	0.53	ND (0.49)	ND (0.43)	1.5	ND (0.47)	ND (0.47)	1.0	ND (0.49)	0.73
Ru-106	ND	26	19	19	21	18	19	16	20	16	ND	24	16	15	18	17
Mn-54	ND	ND	ND	ND	ND	ND	ND	ND	ND	ND	ND	ND	ND	ND	ND	ND
Co-60	ND	ND	ND	ND	ND	ND	ND	ND	ND	ND	ND	ND	ND	ND	ND	0.50
Sb-125	ND	ND	ND	ND	ND	ND	ND	ND	ND	ND	ND	ND	ND	ND	1.7	ND
Gross β	150	1,900	1,300	1,700	1,600	1,200	1,300	1,500	1,400	1,400	1,300	1,500	1,800	1,600	1,500	1,400
H-3	29,000	500,000	460,000	500,000	470,000	450,000	440,000	430,000	450,000	430,000	420,000	430,000	410,000	390,000	400,000	420,000
Sr-90	8.6	1,000	890	1,200	1,200	Under measurement	Under measurement	Under measurement	-	-	-	-	-	-	-	-

* "ND" indicates that the measurement result is below the detection limit, and the detection limit of each nuclide is provided in parentheses.

¹ As of γ nuclide measurement, the amount is lower than true value since the high BG is in use.

Sampling date	2013/7/22	2013/7/25	2013/7/29	2013/8/1	2013/8/5	2013/8/8	2013/8/12	2013/8/15	2013/8/19	2013/8/22	2013/8/26	2013/8/29	2013/8/30	2013/9/2	2013/9/5	2013/9/9
Sampling time	1:21 PM	1:15 PM	11:50 AM	11:55 AM	12:23 PM	11:29 AM	10:46 AM	12:01 PM	10:21 AM	10:58 AM	10:36 AM	10:15 AM	11:25 AM	10:07 AM	9:40 AM	10:51 AM
Cs-134	ND (0.42)	ND (0.42)	ND (0.46)	ND (0.44)	ND (0.52)	0.52	ND (0.42)	ND (0.54)	3.2	ND (0.57)	ND (0.47)	13	0.98	1.5	2.5	ND (0.40)
Cs-137	ND (0.45)	ND (0.55)	ND (0.51)	0.55	0.62	1.1	0.50	ND (0.49)	4.3	0.66	0.84	31	2.1	3.5	5.7	0.72
Ru-106	ND	12	17	14	17	15	12	11	14	7.9	14	17	17	11	12	12
Mn-54	ND	ND	ND	ND	ND	ND	ND	ND	ND	ND	ND	ND	ND	ND	ND	ND
Co-60	ND	ND	ND	ND	ND	ND	ND	ND	ND	ND	ND	ND	ND	ND	ND	ND
Sb-125	ND	ND	ND	ND	ND	ND	ND	ND	ND	ND	ND	ND	ND	ND	ND	ND
Gross β	1,400	1,400	1,300	1,300	1,400	1,300	1,700	1,700	1,500	1,500	1,500	1,400	1,700	1,300	1,500	650
H-3	430,000	430,000	420,000	440,000	430,000	430,000	380,000	370,000	310,000	430,000	420,000	390,000	390,000	400,000	370,000	350,000
Sr-90	-	Under measurement	-	-	-	-	-	-	-	Under measurement	-	-	-	-	-	-

* "ND" indicates that the measurement result is below the detection limit, and the detection limit of each nuclide is provided in parentheses.

Sampling date	2013/9/12	2013/9/16	2013/9/19	2013/9/23	2013/9/26	2013/9/30	2013/10/3	2013/10/7	2013/10/10	2013/10/14	2013/10/17	2013/10/21	2013/10/24	2013/10/28	2013/10/31	2013/11/4
Sampling time	9:30 AM	10:25 AM	10:02 AM	11:11 AM	9:51 AM	9:45 AM	10:28 AM	10:35 AM	10:00 AM	1:05 PM	10:15 AM	12:24 PM	12:55 PM	11:14 AM	10:59 AM	10:11 AM
Cs-134	ND (0.46)	ND (0.57)	ND (0.43)	ND (0.44)	ND (0.45)	ND (0.49)	ND (0.52)	ND (0.56)	ND (0.51)	ND (0.39)	ND (0.40)	ND (0.45)	ND (0.44)	ND (0.40)	ND (0.45)	ND (0.47)
Cs-137	ND (0.58)	ND (0.67)	ND (0.57)	0.81	1.1	ND (0.59)	0.62	ND (0.58)	1.4	0.74	0.59	ND (0.54)	0.57	0.51	ND (0.54)	ND (0.48)
Ru-106	6.5	7.6	7.0	7.3	6.2	6.0	4.4	4.4	6.0	5.6	ND	5.3	6.1	ND	5.6	ND
Mn-54	ND	ND	ND	ND	ND	ND	ND	ND	ND	ND	ND	ND	ND	ND	ND	ND
Co-60	ND	ND	ND	ND	ND	ND	ND	ND	ND	ND	ND	ND	ND	ND	ND	ND
Sb-125	ND	ND	ND	ND	ND	ND	ND	1.2	ND	ND	ND	ND	ND	ND	ND	ND
Gross β	1,000	940	770	820	510	560	660	430	310	670	450	330	380	570	420	420
H-3	360,000	360,000	330,000	310,000	330,000	290,000	280,000	270,000	290,000	260,000	250,000	250,000	240,000	240,000	230,000	230,000
Sr-90	-	-	Under measurement	-	-	-	-	-	-	Under measurement	-	-	-	-	-	-

* "ND" indicates that the measurement result is below the detection limit, and the detection limit of each nuclide is provided in parentheses.

Sampling date	2013/11/7	2013/11/11	2013/11/14	2013/11/18	2013/11/21	2013/11/25	2013/11/28	2013/12/2
Sampling time	10:10 AM	10:02 AM	10:45 AM	10:12 AM	10:50 AM	10:43 AM	10:01 AM	10:52 AM
Cs-134	ND (0.43)	ND (0.36)	ND (0.48)	ND (0.50)	0.47	ND (0.43)	ND (0.47)	ND (0.41)
Cs-137	ND (0.54)	0.66	0.54	0.70	1.2	ND (0.45)	ND (0.54)	ND (0.49)
Ru-106	3.7	ND	3.9	ND	2.8	4.6	ND	3.5
Mn-54	ND	ND	ND	ND	ND	ND	ND	ND
Co-60	ND	ND	ND	ND	ND	ND	ND	ND
Sb-125	ND	ND	ND	ND	ND	ND	ND	ND
Gross β	370	440	490	480	430	570	490	470
H-3	230,000	220,000	380,000	220,000	230,000	230,000	220,000	Under measurement
Sr-90	-	-	Under measurement	-	-	-	-	-

* "ND" indicates that the measurement result is below the detection limit, and the detection limit of each nuclide is provided in parentheses.

Groundwater observation hole No.1 (Bq/L) * Observation hole where sampling could not be performed due to the ground improvement construction

Sampling date	2013/6/28	2013/7/1	2013/7/5	2013/7/8
Sampling time	4:40 PM	4:05 PM	11:00 AM	2:35 PM
Cs-134	ND (0.41)	ND (0.44)	ND (0.42)	1.9
Cs-137	ND (0.51)	0.98	0.55	3.6
Ru-106	ND	7.8	7.7	7.9
Mn-54	0.52	0.92	1.0	0.78
Co-60	ND	ND	ND	ND
Sb-125	ND	ND	ND	ND
Gross β	3,000	4,300	3,800	4,400
H-3	430,000	510,000	600,000	630,000
Sr-90	Under measurement	-	-	-

* "ND" indicates that the measurement result is below the detection limit, and the detection limit of each nuclide is provided in parentheses.

Groundwater observation hole No.1-2 (Bq/L) * Observation hole where sampling could not be performed due to the ground improvement construction

Sampling date	2013/7/5	2013/7/8	2013/7/8 (Filtration)	2013/7/9	2013/7/9 (Filtration)	2013/7/9 (Residue)	2013/7/11	2013/7/11 (Filtration)	2013/7/15	2013/7/15 (Filtration)	2013/7/18	2013/7/18 (Filtration)	2013/7/22	2013/7/22 (Filtration)	2013/7/25	2013/7/25 (Filtration)
Sampling time	12:10 PM	2:00 PM	2:00 PM	1:00 PM	1:00 PM	1:00 PM	1:25 PM	1:25 PM	1:23 PM	1:23 PM	1:23 PM	1:23 PM	1:47 PM	1:47 PM	2:00 PM	2:00 PM
Cs-134	99	9,000	94	11,000	130	10,000	8,200	98	5,900	ND (21)	5,400	ND (25)	3,500	50	2,600	ND (22)
Cs-137	210	18,000	190	22,000	270	20,000	17,000	150	12,000	ND (21)	11,000	ND (25)	7,300	71	5,400	25
Ru-106	95	ND	/	ND	/	/	ND	/	ND	/	ND	/	ND	/	ND	/
Mn-54	62	25	/	ND	/	/	ND	/	ND	/	ND	/	ND	/	ND	/
Co-60	1.2	3.1	/	ND	/	/	ND	/	ND	/	ND	/	ND	/	ND	/
Sb-125	35	ND	/	ND	/	/	ND	/	250	/	ND	/	ND	/	ND	/
Gross β	900,000	890,000	920,000	900,000	890,000	/	890,000	/	890,000	/	880,000	/	880,000	/	880,000	/
H-3	380,000	360,000	/	370,000	/	/	380,000	/	350,000	/	350,000	/	350,000	/	370,000	/
Sr-90	Under measurement	-	/	-	/	/	-	/	-	/	-	/	-	/	-	/

* "ND" indicates that the measurement result is below the detection limit, and the detection limit of each nuclide is provided in parentheses.

Sampling date	2013/7/29	2013/7/29 (Filtration)	2013/8/1	2013/8/1 (Filtration)	2013/8/5	2013/8/5 (Filtration)	2013/8/8	2013/8/8 (Filtration)	2013/8/12	2013/8/12 (Filtration)	2013/8/15	2013/8/15 (Filtration)	2013/8/19	2013/8/19 (Filtration)	2013/8/22	2013/8/22 (Filtration)
Sampling time	12:10 PM	12:10 PM	12:25 PM	12:25 PM	12:46 PM	12:46 PM	1:38 PM	1:38 PM	12:27 PM	12:27 PM	1:35 PM	1:35 PM	12:06 PM	12:06 PM	12:33 PM	12:33 PM
Cs-134	1,300	ND (18)	760	ND (26)	350	ND (18)	200	19	180	ND (20)	150	ND (18)	880	53	150	110
Cs-137	2,700	ND (21)	1,600	45	750	ND (22)	400	29	400	ND (23)	360	38	1,900	97	360	230
Ru-106	ND	/	ND	/	ND	/	ND	/	ND	/	160	/	ND	/	ND	/
Mn-54	ND	/	ND	/	ND	/	ND	/	ND	/	ND	/	ND	/	ND	/
Co-60	ND	/	ND	/	ND	/	ND	/	ND	/	ND	/	ND	/	ND	/
Sb-125	180	/	110	/	110	/	170	/	130	/	95	/	200	/	ND	/
Gross β	870,000	/	870,000	/	880,000	/	880,000	/	890,000	/	880,000	/	870,000	/	840,000	/
H-3	350,000	/	380,000	/	390,000	/	170,000	/	180,000	/	300,000	/	180,000	/	400,000	/
Sr-90	-	/	-	/	-	/	Under measurement	/	-	/	-	/	-	/	-	/

* "ND" indicates that the measurement result is below the detection limit, and the detection limit of each nuclide is provided in parentheses.

Sampling date	2013/8/26	2013/8/26 (Filtration)	2013/8/29	2013/8/29 (Filtration)	2013/9/2	2013/9/2 (Filtration)	2013/9/5	2013/9/5 (Filtration)	2013/9/9	2013/9/9 (Filtration)	2013/9/12	2013/9/12 (Filtration)	2013/9/16	2013/9/16 (Filtration)	2013/9/19	2013/9/19 (Filtration)
Sampling time	12:35 PM	12:35 PM	11:42 AM	11:42 AM	11:56 AM	11:56 AM	1:40 PM	1:40 PM	1:37 PM	1:37 PM	9:58 AM	9:58 AM	10:54 AM	10:54 AM	10:26 AM	10:26 AM
Cs-134	110	80	120	75	140	66	82	52	54	41	110	35	78	39	90	23
Cs-137	270	170	260	160	300	150	180	100	110	94	270	100	180	96	200	100
Ru-106	ND	/	ND	/	ND	/	ND	/	ND	/	ND	/	ND	/	ND	/
Mn-54	ND	/	ND	/	ND	/	ND	/	ND	/	ND	/	ND	/	ND	/
Co-60	ND	/	ND	/	ND	/	ND	/	ND	/	ND	/	ND	/	ND	/
Sb-125	ND	/	ND	/	ND	/	ND	/	ND	/	ND	/	ND	/	ND	/
Gross β	760,000	/	680,000	/	590,000	/	500,000	/	460,000	/	430,000	/	430,000	/	350,000	/
H-3	380,000	/	380,000	/	350,000	/	310,000	/	280,000	/	310,000	/	430,000	/	290,000	/
Sr-90	-	/	-	/	-	/	-	/	-	/	-	/	-	/	-	/

* "ND" indicates that the measurement result is below the detection limit, and the detection limit of each nuclide is provided in parentheses.

Sampling date	2013/9/23	2013/9/23 (Filtration)	2013/9/26	2013/9/26 (Filtration)	2013/9/30	2013/9/30 (Filtration)	2013/10/3	2013/10/3 (Filtration)	2013/10/7
Sampling time	10:45 AM	10:45 AM	11:55 AM	11:55 AM	11:09 AM	11:09 AM	11:05 AM	11:05 AM	12:06 PM
Cs-134	71	42	150	58	520	370	440	330	1,400
Cs-137	170	75	360	140	1,200	800	970	710	2,800
Ru-106	ND	/	ND	/	ND	/	ND	/	ND
Mn-54	ND	/	ND	/	ND	/	ND	/	ND
Co-60	ND	/	ND	/	ND	/	ND	/	ND
Sb-125	ND	/	ND	/	ND	/	ND	/	ND
Gross β	280,000	/	270,000	/	160,000	/	200,000	/	250,000
H-3	270,000	/	270,000	/	62,000	/	57,000	/	54,000
Sr-90	-	/	-	/	-	/	-	/	-

* "ND" indicates that the measurement result is below the detection limit, and the detection limit of each nuclide is provided in parentheses.

Groundwater observation hole No.1-3 (Bq/L) * Observation hole where sampling could not be performed due to the ground improvement construction

Sampling date	2013/7/12	2013/7/15	2013/7/18	2013/7/22	2013/7/25	2013/7/29	2013/8/1	2013/8/5	2013/8/8	2013/8/12	2013/8/15	2013/8/19	2013/8/22	2013/8/26	2013/8/29	2013/9/2
Sampling time	12:20 PM	1:20 PM	12:36 PM	12:33 PM	12:45 PM	11:26 AM	11:20 AM	11:18 AM	12:18 PM	11:20 AM	12:26 PM	10:54 AM	11:25 AM	11:18 AM	10:38 AM	10:37 AM
Cs-134	ND (0.66)	ND (0.46)	ND (0.39)	ND (0.46)	ND (0.44)	ND (0.44)	ND (0.50)	ND (0.61)	ND (0.55)	ND (0.55)	ND (0.64)	ND (0.56)	1.0	1.1	1.3	10
Cs-137	1.4	ND (0.54)	0.53	ND (0.58)	ND (0.62)	ND (0.47)	0.75	ND (0.60)	1.0	ND (0.67)	ND (0.76)	ND (0.65)	2.3	2.1	3.3	24
Ru-106	16	14	15	17	11	16	15	11	17	12	11	14	12	5.1	4.6	ND
Mn-54	ND	ND	ND	ND	ND	ND	ND	ND	ND	ND	ND	ND	ND	ND	ND	ND
Co-60	ND	ND	ND	ND	ND	ND	ND	ND	ND	ND	ND	ND	ND	ND	ND	ND
Sb-125	1.4	ND	ND	ND	ND	ND	ND	ND	ND	ND	ND	ND	ND	1.4	ND	ND
Gross β	92,000	100,000	120,000	150,000	150,000	150,000	150,000	150,000	150,000	160,000	160,000	120,000	130,000	61,000	33,000	21,000
H-3	290,000	250,000	270,000	260,000	260,000	250,000	250,000	230,000	240,000	210,000	190,000	190,000	220,000	250,000	230,000	200,000
Sr-90	Under measurement	-	-	-	-	-	-	-	Under measurement	-	-	-	-	-	-	-

* "ND" indicates that the measurement result is below the detection limit, and the detection limit of each nuclide is provided in parentheses.

Groundwater observation hole No.1-4 (Bq/L) * Observation hole where sampling could not be performed due to the ground improvement construction

Sampling date	2013/7/8	2013/7/11	2013/7/15	2013/7/18	2013/7/22	2013/7/25	2013/7/29	2013/8/1	2013/8/5	2013/8/8	2013/8/12	2013/8/15	2013/8/19	2013/8/22
Sampling time	3:30 PM	12:25 PM	11:55 AM	12:03 PM	12:18 PM	12:00 PM	10:51 AM	10:43 AM	10:40 AM	11:00 AM	10:21 AM	11:30 AM	9:50 AM	10:20 AM
Cs-134	1.5	0.91	ND (0.41)	0.67	ND (0.43)	0.49	0.48	0.50	ND (0.46)	0.55	ND (0.41)	ND (0.47)	1.1	1.0
Cs-137	3.6	2.0	0.67	1.0	1.1	0.88	1.1	1.4	0.65	1.2	1.3	1.2	2.1	1.8
Ru-106	ND	ND	ND	ND	ND	ND	ND	ND	ND	3.1	ND	ND	ND	ND
Mn-54	ND	ND	ND	ND	ND	ND	ND	ND	ND	ND	ND	ND	ND	ND
Co-60	ND	ND	ND	ND	ND	ND	ND	ND	ND	ND	ND	ND	ND	ND
Sb-125	ND	ND	ND	ND	ND	ND	ND	ND	ND	ND	ND	ND	ND	ND
Gross β	330	250	67	50	110	110	78	130	130	170	150	220	380	240
H-3	69,000	98,000	60,000	42,000	46,000	50,000	51,000	57,000	64,000	76,000	72,000	76,000	75,000	21,000
Sr-90	Under measurement	-	-	-	-	-	-	-	-	Under measurement	-	-	-	-

* "ND" indicates that the measurement result is below the detection limit, and the detection limit of each nuclide is provided in parentheses.

Groundwater observation hole No.1-5 (Bq/L) * Observation hole where sampling could not be performed due to the ground improvement construction

Sampling date	2013/7/31	2013/8/5	2013/8/6	2013/8/8	2013/8/12	2013/8/15	2013/8/19	2013/8/22	2013/8/26	2013/8/29	2013/9/2	2013/9/5
Sampling time	1:05 PM	11:55 AM	10:38 AM	1:05 PM	12:00 PM	1:02 PM	11:40 AM	12:00 PM	12:00 PM	11:13 AM	11:16 AM	12:58 PM
Cs-134	21	310	260	250	190	150	130	91	53	62	40	50
Cs-137	44	650	540	520	390	320	260	190	110	130	85	110
Ru-106	ND	ND	ND	ND	ND	ND	ND	ND	ND	ND	ND	ND
Mn-54	ND	ND	ND	ND	ND	ND	ND	ND	ND	ND	ND	ND
Co-60	ND	ND	ND	ND	ND	ND	ND	ND	ND	ND	ND	ND
Sb-125	ND	ND	6.7	12	8.9	9.3	ND	ND	ND	ND	ND	ND
Gross β	1,200	56,000	47,000	52,000	26,000	21,000	13,000	6,200	3,400	2,600	2,000	820
H-3	28,000	56,000	45,000	57,000	70,000	72,000	56,000	28,000	30,000	24,000	23,000	23,000
Sr-90	Under measurement	-	-	-	-	-	-	Under measurement	-	-	-	-

* "ND" indicates that the measurement result is below the detection limit, and the detection limit of each nuclide is provided in parentheses.

Groundwater observation hole No.1-8 (Bq/L)

Sampling date	2013/8/20	2013/8/26	2013/9/2	2013/9/9	2013/9/16	2013/9/23	2013/9/30	2013/10/7	2013/10/14	2013/10/21	2013/10/28	2013/11/4	2013/11/11	2013/11/18	2013/11/25	2013/12/2
Sampling time	9:40 AM	9:36 AM	9:37 AM	10:15 AM	10:00 AM	9:40 AM	9:00 AM	9:36 AM	9:30 AM	11:00 AM	9:17 AM	9:14 AM	9:10 AM	9:11 AM	9:23 AM	9:26 AM
Cs-134	21	26	30	17	31	20	17	23	24	24	43	20	31	41	47	38
Cs-137	45	58	63	37	67	45	37	49	53	58	95	45	69	96	110	88
Ru-106	ND	ND	ND	ND	ND	ND	ND	ND	ND	ND	ND	ND	ND	ND	ND	ND
Mn-54	ND	0.52	ND	ND	0.76	0.46	ND	1.0	0.67	0.64	2.6	1.1	3.6	5.2	7.1	7.1
Co-60	ND	ND	ND	ND	ND	ND	ND	ND	ND	ND	0.44	ND	ND	0.58	ND	ND
Sb-125	ND	ND	ND	ND	ND	ND	ND	ND	ND	ND	ND	ND	ND	ND	ND	ND
Gross β	1,100	1,200	1,100	370	2,100	1,900	1,500	100	2,500	3,700	11,000	4,400	11,000	14,000	18,000	17,000
H-3	950	840	1,100	1,200	1,900	2,100	1,700	2,100	2,500	2,000	2,000	1,600	2,700	4,900	6,600	Under measurement
Sr-90	Under measurement	-	-	-	Under measurement	-	-	-	Under measurement	-	-	-	Under measurement	-	-	-

* "ND" indicates that the measurement result is below the detection limit, and the detection limit of each nuclide is provided in parentheses.

Groundwater observation hole No.1-9 (Bq/L)

Sampling date	2013/9/3	2013/9/3 (Filtration)	2013/9/5	2013/9/5 (Filtration)	2013/9/8	2013/9/10	2013/9/12	2013/9/15	2013/9/17	2013/9/19	2013/9/22	2013/9/24	2013/9/26	2013/9/29	2013/10/1	2013/10/3
Sampling time	10:20 AM	10:20 AM	10:20 AM	10:20 AM	8:40 AM	6:20 AM	6:55 AM	6:06 AM	6:30 AM	6:24 AM	6:22 AM	6:16 AM	6:16 AM	6:18 AM	6:23 AM	6:15 AM
Cs-134	170	66	110	41	59	33	8.7	45	29	19	17	10	11	11	12	9.5
Cs-137	380	120	240	110	140	77	20	100	69	45	40	23	25	25	28	25
Ru-106	ND	ND	ND	ND	ND	ND	ND	ND	ND	ND	ND	ND	ND	ND	ND	ND
Mn-54	ND	ND	ND	ND	ND	ND	ND	ND	ND	ND	ND	ND	ND	ND	ND	ND
Co-60	ND	ND	ND	ND	ND	ND	ND	ND	ND	ND	ND	ND	ND	ND	ND	ND
Sb-125	ND	ND	ND	ND	ND	ND	ND	ND	ND	ND	ND	ND	ND	ND	ND	ND
Gross β	470	ND	540	ND	600	200	270	350	260	240	230	160	310	250	140	83
H-3	670	ND	580	ND	560	380	650	680	570	650	600	680	690	550	770	690
Sr-90	Under measurement	Under measurement	Under measurement	Under measurement	-	-	-	-	-	-	-	-	-	-	-	Under measurement

* "ND" indicates that the measurement result is below the detection limit, and the detection limit of each nuclide is provided in parentheses.

Sampling date	2013/10/6	2013/10/8	2013/10/10	2013/10/13	2013/10/15	2013/10/17	2013/10/20	2013/10/22	2013/10/24	2013/10/27	2013/10/29	2013/10/31	2013/11/3	2013/11/5	2013/11/7	2013/11/10
Sampling time	6:22 AM	6:30 AM	6:25 AM	5:58 AM	6:13 AM	6:39 AM	6:18 AM	6:29 AM	6:15 AM	6:15 AM	6:20 AM	6:15 AM	6:20 AM	6:12 AM	6:23 AM	6:31 AM
Cs-134	7.9	6.7	9.2	10	5.4	36	5.7	4.9	3.4	9.3	5.5	6.0	2.5	3.0	3.5	16
Cs-137	19	16	21	24	13	79	13	14	7.9	22	11	15	7.4	7.5	8.6	40
Ru-106	ND	ND	ND	ND	ND	ND	ND	ND	ND	ND	ND	ND	ND	ND	ND	ND
Mn-54	ND	ND	ND	ND	ND	ND	ND	ND	ND	ND	ND	ND	ND	ND	ND	ND
Co-60	ND	ND	ND	ND	ND	ND	ND	ND	ND	ND	ND	ND	ND	ND	ND	ND
Sb-125	ND	ND	ND	ND	ND	ND	ND	ND	ND	ND	ND	ND	ND	ND	ND	ND
Gross β	110	89	71	120	120	300	88	69	62	78	86	57	87	86	94	64
H-3	460	630	620	670	590	270	670	590	540	700	480	590	440	530	440	550
Sr-90	-	-	-	-	-	-	-	-	-	-	-	-	Under measurement	-	-	-

* "ND" indicates that the measurement result is below the detection limit, and the detection limit of each nuclide is provided in parentheses.

Sampling date	2013/11/12	2013/11/14	2013/11/17	2013/11/18	2013/11/19	2013/11/21	2013/11/24	2013/11/26	2013/11/28	2013/12/1	2013/12/3
Sampling time	6:31 AM	6:27 AM	6:16 AM	5:55 AM	6:25 AM	6:48 AM	6:37 AM	6:57 AM	6:47 AM	6:58 AM	7:03 AM
Cs-134	12	3.4	13	9.3	3.3	3.0	2.9	3.3	26	3.3	42
Cs-137	31	8.8	30	23	8.8	7.7	7.6	8.5	63	7.7	110
Ru-106	ND	ND	ND	ND	ND	ND	ND	ND	ND	ND	ND
Mn-54	ND	ND	ND	ND	ND	ND	ND	ND	ND	ND	ND
Co-60	ND	ND	ND	ND	ND	ND	ND	ND	ND	ND	ND
Sb-125	ND	ND	ND	ND	ND	ND	ND	ND	ND	ND	ND
Gross β	94	76	2,100	470	710	900	350	340	230	200	160
H-3	810	860	720	550	510	500	440	460	510	580	Under measurement
Sr-90	-	Under measurement	-	-	-	-	-	-	-	-	-

* "ND" indicates that the measurement result is below the detection limit, and the detection limit of each nuclide is provided in parentheses.

Groundwater observation hole No.1-11 (Bq/L)

Sampling date	2013/9/13	2013/9/16	2013/9/19	2013/9/23	2013/9/26	2013/9/30	2013/10/3	2013/10/7	2013/10/10	2013/10/14	2013/10/17	2013/10/21	2013/10/24	2013/10/28	2013/10/31	2013/11/4
Sampling time	10:35 AM	9:35 AM	9:35 AM	10:10 AM	9:25 AM	9:23 AM	9:22 AM	10:02 AM	9:34 AM	9:57 AM	9:30 AM	11:57 AM	10:50 AM	9:50 AM	9:50 AM	9:36 AM
Cs-134	ND (0.36)	ND (0.40)	ND (0.48)	0.44	0.45	ND (0.48)	0.43	0.55	0.67	0.92	0.56	ND (0.41)	0.43	0.41	0.94	0.68
Cs-137	0.48	ND (0.58)	0.74	1.2	1.1	1.0	1.4	0.82	2.00	1.8	1.3	1.2	1.2	1.3	1.8	1.2
Ru-106	ND	ND	ND	ND	ND	ND	ND	ND	ND	ND	ND	ND	ND	ND	ND	ND
Mn-54	ND	ND	ND	ND	ND	ND	ND	ND	ND	ND	ND	ND	ND	ND	ND	ND
Co-60	ND	ND	ND	ND	ND	ND	ND	ND	ND	ND	ND	ND	ND	ND	ND	ND
Sb-125	ND	ND	ND	ND	ND	ND	ND	ND	ND	ND	ND	ND	ND	ND	ND	ND
Gross β	43	42	57	29	36	32	72	31	46	49	64	29	32	29	19	22
H-3	85,000	72,000	68,000	76,000	55,000	43,000	48,000	36,000	32,000	33,000	26,000	25,000	22,000	24,000	20,000	22,000
Sr-90	Under measurement	-	-	-	-	-	-	-	-	Under measurement	-	-	-	-	-	-

* "ND" indicates that the measurement result is below the detection limit, and the detection limit of each nuclide is provided in parentheses.

Sampling date	2013/11/7	2013/11/11	2013/11/14	2013/11/18	2013/11/21	2013/11/25	2013/11/28	2013/12/2
Sampling time	9:01 AM	9:36 AM	10:28 AM	9:30 AM	11:10 AM	10:10 AM	10:40 AM	9:50 AM
Cs-134	0.55	0.75	0.56	0.62	0.49	0.73	0.61	0.92
Cs-137	1.3	2.0	1.3	1.4	1.7	1.5	1.4	2.2
Ru-106	ND	ND	ND	ND	ND	ND	ND	ND
Mn-54	ND	ND	ND	ND	ND	ND	ND	ND
Co-60	ND	ND	ND	ND	ND	ND	ND	ND
Sb-125	ND	ND	ND	ND	ND	ND	ND	ND
Gross β	22	42	18	53	ND (17)	25	35	46
H-3	21,000	17,000	20,000	18,000	18,000	25,000	22,000	Under measurement
Sr-90	-	Under measurement	-	-	-	-	-	-

* "ND" indicates that the measurement result is below the detection limit, and the detection limit of each nuclide is provided in parentheses.

Groundwater observation hole No.1-12 (Bq/L)

Sampling date	2013/10/21	2013/10/24	2013/10/28	2013/10/31	2013/11/4	2013/11/7	2013/11/11	2013/11/14	2013/11/18	2013/11/21	2013/11/25	2013/11/28	2013/12/2
Sampling time	11:22 AM	12:10 PM	10:14 AM	10:15 AM	9:20 AM	9:30 AM	9:11 AM	9:35 AM	9:17 AM	9:46 AM	9:45 AM	9:14 AM	9:40 AM
Cs-134	74	36	26	15	14	12	9.0	7.9	8.5	8.0	7.9	8.0	6.3
Cs-137	170	80	62	29	33	30	21	19	19	17	18	19	17
Ru-106	ND	ND	5.4	ND	ND	ND	ND	ND	ND	ND	ND	ND	ND
Mn-54	ND	ND	ND	ND	ND	ND	ND	ND	ND	ND	ND	ND	ND
Co-60	ND	0.51	ND	ND	ND	ND	ND	ND	ND	ND	ND	ND	ND
Sb-125	61	17	6.0	2.1	ND	ND	ND	ND	ND	ND	ND	ND	ND
Gross β	730	640	410	150	200	350	160	110	130	89	100	75	85
H-3	350,000	390,000	420,000	440,000	420,000	370,000	390,000	230,000	330,000	280,000	230,000	210,000	Under measurement
Sr-90	Under measurement	-	-	-	-	-	Under measurement	-	-	-	-	-	-

* "ND" indicates that the measurement result is below the detection limit, and the detection limit of each nuclide is provided in parentheses.

Groundwater observation hole No.1-14 (Bq/L)

Sampling date	2013/11/10	2013/11/14	2013/11/18	2013/11/21	2013/11/25	2013/11/28	2013/12/2
Sampling time	12:30 PM	10:15 AM	9:45 AM	10:25 AM	10:20 AM	9:40 AM	9:58 AM
Cs-134	0.84	1.2	0.90	0.78	0.69	0.75	0.60
Cs-137	2.0	1.8	2.1	2.3	1.6	2.1	1.4
Ru-106	ND	ND	ND	ND	ND	ND	ND
Mn-54	ND	ND	ND	ND	ND	ND	ND
Co-60	ND	ND	ND	ND	ND	ND	ND
Sb-125	ND	ND	ND	ND	ND	ND	ND
Gross β	33	22	28	160	140	96	110
H-3	2,600	3,600	3,600	4,700	11,000	6,200	Under measurement
Sr-90	Under measurement	-	-	-	-	-	-

* "ND" indicates that the measurement result is below the detection limit, and the detection limit of each nuclide is provided in parentheses.

Groundwater observation hole No.1-16 (Bq/L)

Sampling date	2013/9/26	2013/9/30	2013/10/3	2013/10/7	2013/10/10	2013/10/14	2013/10/17	2013/10/21	2013/10/24	2013/10/28	2013/10/31	2013/11/4	2013/11/7	2013/11/11	2013/11/14	2013/11/18
Sampling time	11:30 AM	10:38 AM	10:05 AM	11:02 AM	10:24 AM	12:43 PM	9:50 AM	11:54 AM	12:30 PM	10:43 AM	10:35 AM	9:45 AM	9:50 AM	9:35 AM	9:55 AM	9:36 AM
Cs-134	ND (0.99)	ND (1.8)	1.5	1.4	ND (1.0)	ND (0.96)	ND (0.98)	ND (0.71)	ND (1.1)	ND (1.4)	ND (1.6)	ND (1.2)	1.1	ND (1.4)	1.6	ND (1.5)
Cs-137	2.1	2.3	2.9	2.6	3.4	2.1	1.8	1.2	1.2	1.4	2.4	ND (0.81)	1.3	2.0	1.7	1.6
Ru-106	ND	ND	ND	ND	ND	ND	ND	ND	ND	9.2	ND	7.7	7.5	ND	9.1	ND
Mn-54	ND	ND	ND	ND	ND	ND	ND	ND	ND	ND	ND	ND	ND	ND	ND	ND
Co-60	ND	ND	ND	0.54	ND	ND	ND	ND	0.46	0.64	0.87	0.49	0.90	0.53	0.52	ND
Sb-125	ND	ND	ND	ND	ND	ND	ND	ND	ND	4.5	5.2	5.5	5.8	7.5	6.1	8.6
Gross β	400,000	450,000	680,000	700,000	740,000	880,000	830,000	390,000	310,000	650,000	550,000	540,000	590,000	650,000	660,000	750,000
H-3	43,000	37,000	34,000	36,000	32,000	30,000	21,000	8,700	11,000	14,000	11,000	14,000	18,000	20,000	21,000	23,000
Sr-90	Under measurement	-	-	-	-	Under measurement	-	-	-	-	-	-	-	Under measurement	-	-

* "ND" indicates that the measurement result is below the detection limit, and the detection limit of each nuclide is provided in parentheses.

Groundwater observation hole No.1-17 (Bq/L)

Sampling date	2013/11/21	2013/11/25	2013/11/28	2013/12/2
Sampling time	10:15 AM	10:00 AM	9:29 AM	10:09 AM
Cs-134	ND (1.2)	ND (1.6)	ND (2.8)	ND (1.9)
Cs-137	1.8	1.5	1.3	1.4
Ru-106	ND	ND	ND	ND
Mn-54	ND	ND	ND	ND
Co-60	0.63	0.56	0.56	0.62
Sb-125	7.0	6.8	7.7	7.7
Gross β	750,000	910,000	1,100,000	1,300,000
H-3	25,000	30,000	34,000	Under measurement
Sr-90	-	-	-	-

Sampling date	2013/11/22	2013/11/25	2013/11/28	2013/12/2
Sampling time	9:23 AM	11:00 AM	10:19 AM	10:34 AM
Cs-134	ND (0.49)	ND (0.52)	ND (0.59)	ND (0.51)
Cs-137	ND (0.48)	ND (0.49)	ND (0.44)	ND (0.48)
Ru-106	4.0	ND	4.0	ND
Mn-54	ND	ND	ND	ND
Co-60	0.41	0.61	0.61	0.37
Sb-125	ND	2.1	2.0	1.6
Gross β	44	78	74	130
H-3	9,800	10,000	12,000	Under measurement
Sr-90	Under measurement	-	-	-

* "ND" indicates that the measurement result is below the detection limit, and the detection limit of each nuclide is provided in parentheses.

* "ND" indicates that the measurement result is below the detection limit, and the detection limit of each nuclide is provided in parentheses.

Groundwater pumped up from the well point between Unit 1 and 2 (Bq/L)

Sampling date	2013/8/19	2013/8/26	2013/9/2	2013/9/9	2013/9/16	2013/9/23	2013/9/30	2013/10/7	2013/10/14	2013/10/21	2013/10/28	2013/11/4	2013/11/11	2013/11/18	2013/11/25	2013/12/2
Sampling time	11:20 AM	10:30 AM	9:35 AM	1:30 PM	9:45 AM	9:30 AM	8:55 AM	9:35 AM	9:15 AM	10:45 AM	9:40 AM	9:10 AM	9:10 AM	9:13 AM	10:20 AM	3:20 PM
Cs-134	1.5	1.0	ND (1.6)	ND (0.63)	15	110	30	20	0.96	5.0	1.3	ND (0.67)	ND (1.1)	1.2	1.4	0.86
Cs-137	3.4	2.1	ND (1.6)	ND (0.68)	32	250	69	43	2.7	13	3.2	1.1	1.3	2.7	3.1	2.7
Ru-106	17	9.7	25	9.0	12	ND	ND	ND	12	8.2	ND	ND	8.7	5.3	5.6	7.3
Mn-54	ND	ND	ND	ND	ND	ND	ND	ND	ND	ND	ND	ND	ND	ND	ND	ND
Co-60	ND	ND	ND	ND	ND	ND	ND	ND	ND	ND	ND	ND	ND	ND	ND	ND
Sb-125	ND	ND	ND	ND	ND	ND	ND	ND	ND	ND	ND	ND	ND	ND	ND	ND
Gross β	190,000	5,900	360,000	89,000	450,000	700,000	490,000	610,000	250,000	330,000	230,000	90,000	240,000	17,000	14,000	20,000
H-3	460,000	260,000	380,000	220,000	290,000	340,000	240,000	200,000	250,000	130,000	99,000	92,000	96,000	75,000	81,000	84,000
Sr-90	-	-	-	-	-	-	-	-	-	-	-	-	-	-	-	-

* "ND" indicates that the measurement result is below the detection limit, and the detection limit of each nuclide is provided in parentheses.

Groundwater observation hole No.2 (Bq/L)

Sampling date	2012/12/8*	2013/5/24	2013/5/31	2013/6/7 (1)	2013/6/7 (2)	2013/6/21	2013/6/28	2013/7/1	2013/7/4	2013/7/8	2013/7/9	2013/7/11	2013/7/15	2013/7/18	2013/7/22	2013/7/25
Sampling time	11:00 AM	4:12 PM	3:16 PM	4:05 PM	4:05 PM	5:44 PM	2:30 PM	4:55 PM	1:05 PM	1:00 PM	12:25 PM	11:30 AM	10:50 AM	11:22 AM	11:37 AM	11:04 AM
Cs-134	ND (0.61)	ND (0.37)	ND (0.41)	0.47 (0.47)	ND (0.37)	ND (0.32)	ND (0.40)	0.48 (0.39)	ND (0.39)	ND (0.49)	0.50 (0.43)	ND (0.47)	ND (0.37)	ND (0.36)	ND (0.44)	ND (0.39)
Cs-137	ND (0.81)	ND (0.41)	0.95 (0.41)	0.73 (0.48)	ND (0.37)	ND (0.37)	ND (0.48)	0.66 (0.46)	ND (0.46)	0.74 (0.49)	0.74 (0.44)	1.2 (0.44)	0.50 (0.44)	ND (0.53)	0.46 (0.44)	0.46 (0.37)
Ru-106	ND	ND	ND	ND	ND	ND	ND	ND	ND	ND	ND	ND	ND	ND	ND	ND
Mn-54	ND	ND	ND	ND	ND	ND	ND	ND	ND	ND	ND	ND	ND	ND	ND	ND
Co-60	ND	ND	ND	ND	ND	ND	ND	ND	ND	ND	ND	ND	ND	ND	ND	ND
Sb-125	ND	ND	ND	ND	ND	ND	ND	ND	ND	ND	ND	ND	ND	ND	ND	ND
Gross β	55	53	76	ND (18)	ND (18)	53	170	260	93	1,700	910	1,400	49	1,100	430	330
H-3	410	380	340	390	340	560	850	740	530	730	670	410	530	540	710	500
Sr-90	8.2	28	54	5.2	5.1	Under measurement	-	-	-	-	-	-	-	-	-	-

* "ND" indicates that the measurement result is below the detection limit, and the detection limit of each nuclide is provided in parentheses.

*1 As of γ nuclide measurement, the amount is lower than true value since the high BG is in use.

Sampling date	2013/7/29	2013/8/1	2013/8/5	2013/8/8	2013/8/12	2013/8/15	2013/8/19	2013/8/22	2013/8/26	2013/8/29	2013/9/1	2013/9/4	2013/9/8	2013/9/11	2013/9/15	2013/9/18
Sampling time	11:30 AM	12:05 PM	11:18 AM	11:36 AM	11:10 AM	11:32 AM	9:57 AM	9:25 AM	10:15 AM	10:10 AM	10:00 AM	10:10 AM	11:50 AM	9:27 AM	11:05 AM	9:24 AM
Cs-134	ND (0.40)	ND (0.35)	ND (0.42)	ND (0.39)	ND (0.38)	ND (0.46)	ND (0.42)	ND (0.41)	ND (0.43)	ND (0.43)	ND (0.41)	ND (0.44)	ND (0.47)	0.36 (0.36)	ND (0.36)	ND (0.37)
Cs-137	ND (0.47)	1.2 (0.53)	ND (0.53)	ND (0.49)	ND (0.48)	ND (0.53)	0.68 (0.47)	0.74 (0.51)	0.66 (0.50)	ND (0.54)	ND (0.55)	0.53 (0.44)	0.70 (0.47)	0.64 (0.44)	0.85 (0.44)	ND (0.44)
Ru-106	ND	ND	ND	ND	ND	ND	ND	ND	ND	ND	ND	ND	ND	ND	ND	ND
Mn-54	ND	ND	ND	ND	ND	ND	ND	ND	ND	ND	ND	ND	ND	ND	ND	ND
Co-60	ND	ND	ND	ND	ND	ND	ND	ND	ND	ND	ND	ND	ND	ND	ND	ND
Sb-125	ND	ND	ND	ND	ND	ND	ND	ND	ND	ND	ND	ND	ND	ND	ND	ND
Gross β	400	210	450	390	210	200	420	270	86	140	230	300	220	96	140	260
H-3	660	640	700	670	580	550	730	450	440	590	670	680	540	520	590	800
Sr-90	-	-	-	-	-	-	-	-	-	-	-	-	-	-	-	-

* "ND" indicates that the measurement result is below the detection limit, and the detection limit of each nuclide is provided in parentheses.

Sampling date	2013/9/22	2013/9/25	2013/9/29	2013/10/2	2013/10/6	2013/10/9	2013/10/13	2013/10/17	2013/10/20	2013/10/23	2013/10/27	2013/10/30	2013/11/3	2013/11/6	2013/11/10	2013/11/13
Sampling time	9:34 AM	9:31 AM	9:33 AM	9:17 AM	9:20 AM	9:40 AM	9:21 AM	10:39 AM	9:45 AM	10:30 AM	9:30 AM	9:58 AM	9:20 AM	9:35 AM	9:30 AM	9:16 AM
Cs-134	ND (0.48)	ND (0.42)	0.49 (0.42)	ND (0.35)	ND (0.46)	ND (0.37)	ND (0.42)	ND (0.36)	ND (0.39)	ND (0.40)	ND (0.43)	ND (0.38)	ND (0.36)	ND (0.39)	ND (0.39)	ND (0.39)
Cs-137	0.67 (0.47)	0.52 (0.53)	0.94 (0.53)	ND (0.45)	ND (0.53)	ND (0.46)	ND (0.47)	ND (0.51)	ND (0.50)	0.57 (0.47)	0.72 (0.43)	0.65 (0.44)	0.65 (0.44)	0.57 (0.44)	0.82 (0.44)	0.76 (0.44)
Ru-106	ND	ND	ND	ND	ND	ND	ND	ND	ND	ND	ND	ND	ND	ND	ND	ND
Mn-54	ND	ND	ND	ND	ND	ND	ND	ND	ND	ND	ND	ND	ND	ND	ND	ND
Co-60	ND	ND	ND	ND	ND	ND	ND	ND	ND	ND	ND	ND	ND	ND	ND	ND
Sb-125	ND	ND	ND	ND	ND	ND	ND	ND	ND	ND	ND	ND	ND	ND	ND	ND
Gross β	380	480	290	180	140	130	180	340	450	390	230	270	260	290	250	320
H-3	680	720	740	600	670	800	800	820	770	700	650	740	740	710	630	510
Sr-90	-	-	-	-	-	-	-	-	-	-	-	-	-	-	-	-

* "ND" indicates that the measurement result is below the detection limit, and the detection limit of each nuclide is provided in parentheses.

Sampling date	2013/11/17	2013/11/20	2013/11/24	2013/11/27	2013/12/1	2013/12/4
Sampling time	9:20 AM	9:28 AM	9:28 AM	9:25 AM	9:30 AM	9:42 AM
Cs-134	ND (0.44)	ND (0.41)	ND (0.40)	ND (0.42)	ND (0.45)	ND (0.43)
Cs-137	0.84 (0.42)	ND (0.45)	ND (0.54)	ND (0.52)	0.72 (0.43)	0.88 (0.43)
Ru-106	ND	ND	ND	ND	ND	ND
Mn-54	ND	ND	ND	ND	ND	ND
Co-60	ND	ND	ND	ND	ND	ND
Sb-125	ND	ND	ND	ND	ND	ND
Gross β	270	310	340	310	300	450
H-3	710	660	760	810	790	Under measurement
Sr-90	-	-	-	-	-	-

* "ND" indicates that the measurement result is below the detection limit, and the detection limit of each nuclide is provided in parentheses.

Groundwater observation hole No.2-1 (Bq/L) * Observation hole where sampling could not be performed due to the ground improvement construction

Sampling date	2013/7/25	2013/7/29	2013/8/1	2013/8/5	2013/8/8	2013/8/12	2013/8/15	2013/8/19	2013/8/22	2013/8/26	2013/8/29	2013/9/1	2013/9/4
Sampling time	11:28 AM	10:53 AM	11:19 AM	10:40 AM	11:05 AM	10:34 AM	10:56 AM	9:18 AM	9:57 AM	9:45 AM	9:36 AM	9:30 AM	9:40 AM
Cs-134	ND (0.42)	ND (0.43)	0.44 (0.43)	ND (0.44)	ND (0.44)	ND (0.37)	ND (0.45)	ND (0.43)	ND (0.43)	ND (0.43)	ND (0.43)	0.66 (0.43)	ND (0.40)
Cs-137	0.69 (0.42)	1.0 (0.43)	0.95 (0.43)	0.55 (0.43)	0.69 (0.43)	0.48 (0.43)	ND (0.52)	ND (0.61)	ND (0.56)	ND (0.54)	1.1 (0.43)	1.1 (0.43)	0.82 (0.40)
Ru-106	ND	ND	ND	ND	ND	ND	ND	ND	ND	ND	ND	ND	ND
Mn-54	ND	ND	ND	ND	ND	ND	ND	ND	ND	ND	ND	ND	ND
Co-60	ND	ND	ND	ND	ND	ND	ND	ND	ND	ND	ND	ND	ND
Sb-125	ND	ND	ND	ND	ND	ND	ND	ND	ND	ND	ND	ND	ND
Gross β	ND (17)	380 (17)	ND (17)	ND (22)	ND (18)	ND (19)	ND (18)	ND (18)	17 (18)	ND (18)	ND (20)	ND (19)	29 (19)
H-3	120	170	180	210	210	290	260	330	310	440	370	270	380
Sr-90	Under measurement	-	-	-	-	-	-	-	-	-	-	-	-

* "ND" indicates that the measurement result is below the detection limit, and the detection limit of each nuclide is provided in parentheses.

Groundwater observation hole No.2-5 (Bq/L)

Sampling date	2013/9/25	2013/9/29	2013/11/7	2013/12/4
Sampling time	9:50 AM	9:50 AM	10:00 AM	10:25 AM
Cs-134	3.1	3.7	3.9	5.2
Cs-137	6.9	10.0	9.1	12
Ru-106	ND	ND	ND	ND
Mn-54	0.62	0.77	ND	0.87
Co-60	ND	ND	ND	ND
Sb-125	26	18	14	2.3
Gross β	32,000	46,000	6,000	35,000
H-3	-	1500.00	3,100	Under measurement
Sr-90	-	Under measurement	-	-

*1 The analysis result of γ and gross β was announced on September 29. However, sample will be reanalyzed.
 The analysis result of No.2-5 is the reference value, since we could not sample groundwater by a regular procedure.
 * "ND" indicates that the measurement result is below the detection limit, and the detection limit of each nuclide is provided in parentheses.

Groundwater observation hole No.2-6 (Bq/L)

Sampling date	2013/9/20	2013/9/22	2013/9/25	2013/9/29	2013/10/2	2013/10/6	2013/10/9	2013/10/13	2013/10/17	2013/10/20	2013/10/23	2013/10/27	2013/10/30	2013/11/3	2013/11/6	2013/11/10
Sampling time	10:53 AM	10:51 AM	12:13 PM	10:30 AM	10:01 AM	9:50 AM	10:15 AM	10:00 AM	11:08 AM	10:25 AM	9:55 AM	9:56 AM	10:30 AM	9:48 AM	10:03 AM	9:54 AM
Cs-134	ND (0.39)	0.42	ND (0.44)	ND (0.41)	ND (0.44)	ND (0.38)	ND (0.48)	ND (0.42)	ND (0.43)	ND (0.44)	ND (0.40)	ND (0.44)	0.56	ND (0.39)	ND (0.38)	ND (0.40)
Cs-137	ND (0.45)	0.57	ND (0.56)	0.57	ND (0.58)	ND (0.48)	ND (0.58)	0.61	ND (0.48)	0.60	ND (0.54)	ND (0.52)	0.53	0.51	0.49	ND (0.57)
Ru-106	ND	ND	ND	ND	ND	ND	ND	ND	ND	ND	ND	ND	ND	ND	ND	ND
Mn-54	ND	ND	ND	ND	ND	ND	ND	ND	ND	ND	ND	ND	ND	ND	ND	ND
Co-60	ND	ND	ND	ND	ND	ND	ND	ND	ND	ND	ND	ND	ND	ND	ND	ND
Sb-125	ND	ND	ND	ND	ND	ND	ND	ND	ND	ND	ND	ND	ND	ND	ND	ND
Gross β	ND (18)	ND (17)	ND (18)	ND (18)	ND (19)	24	37	50	120	270	530	850	1,100	1,400	1,700	1,900
H-3	200	210	360	610	840	910	960	1,100	1,100	930	960	1,000	980	1,000	1,100	1,100
Sr-90	Under measurement	-	-	-	-	-	-	-	-	-	-	-	-	-	-	-

* "ND" indicates that the measurement result is below the detection limit, and the detection limit of each nuclide is provided in parentheses.

Sampling date	2013/11/13	2013/11/17	2013/11/20	2013/11/24	2013/11/27	2013/12/1	2013/12/3
Sampling time	9:50 AM	9:45 AM	10:06 AM	10:08 AM	9:53 AM	9:57 AM	9:42 AM
Cs-134	ND (0.44)	ND (0.40)	ND (0.37)	ND (0.48)	ND (0.48)	ND (0.39)	ND (0.41)
Cs-137	ND (0.55)	ND (0.60)	ND (0.46)	ND (0.52)	ND (0.55)	ND (0.46)	ND (0.53)
Ru-106	ND	ND	ND	ND	ND	ND	ND
Mn-54	ND	ND	ND	ND	ND	ND	ND
Co-60	ND	ND	ND	ND	ND	ND	ND
Sb-125	ND	ND	ND	ND	ND	ND	ND
Gross β	2,000	2,100	2,000	2,300	2,500	2,700	3,100
H-3	1,100	980	1,100	1,200	1,200	1,100	Under measurement
Sr-90	-	-	-	-	-	-	-

* "ND" indicates that the measurement result is below the detection limit, and the detection limit of each nuclide is provided in parentheses.

Groundwater observation hole No.2-7 (Bq/L)

Sampling date	2013/11/21	2013/11/24	2013/12/1	2013/12/4
Sampling time	10:35 AM	10:40 AM	10:22 AM	10:20 AM
Cs-134	1.3	0.83	0.88	ND (0.50)
Cs-137	3.1	2.3	2.2	1.9
Ru-106	ND	ND	ND	ND
Mn-54	ND	ND	ND	ND
Co-60	ND	ND	ND	ND
Sb-125	ND	ND	ND	ND
Gross β	18	ND (21)	ND (19)	ND (17)
H-3	1,000	970	940	950
Sr-90	Under measurement	-	-	-

* "ND" indicates that the measurement result is below the detection limit, and the detection limit of each nuclide is provided in parentheses.

Groundwater pumped up from the well point between Unit 2 and 3 (Bq/L)

Sampling date	2013/12/4
Sampling time	10:10 AM
Cs-134	0.75
Cs-137	1.5
Ru-106	ND
Mn-54	ND
Co-60	ND
Sb-125	ND
Gross β	110,000
H-3	Under measurement
Sr-90	-

* "ND" indicates that the measurement result is below the detection limit, and the detection limit of each nuclide is provided in parentheses.

Groundwater observation hole No.3 (Bq/L)

Sampling date	2012/12/12 ¹	2013/5/24	2013/5/31	2013/6/7 ^①	2013/6/7 ^②	2013/6/21	2013/6/26	2013/7/4	2013/7/11	2013/7/18	2013/7/25	2013/8/1	2013/8/2	2013/8/8	2013/9/5
Sampling time	11:00 AM	4:52 PM	3:32 PM	3:58 PM	3:58 PM	5:01 PM	3:50 PM	2:00 PM	10:55 AM	10:45 AM	1:30 PM	12:59 PM	2:25 PM	2:19 PM	8:20 AM
Cs-134	ND (0.60)	0.87	1.6	0.9	0.5	1.7	0.96	1.5	1.9	1.2	3.5	1.8	2.4	2.2	3.0
Cs-137	ND (0.79)	1.4	2.7	2.0	1.6	2.9	2.9	2.8	4.8	3.1	3.9	4.2	4.0	5.9	3.0
Ru-106	ND	ND	ND	ND	ND	ND	ND	ND	ND	ND	ND	ND	ND	ND	ND
Mn-54	ND	ND	ND	ND	ND	ND	ND	ND	ND	ND	ND	ND	ND	ND	ND
Co-60	ND	ND	ND	ND	ND	ND	ND	ND	ND	ND	ND	ND	ND	ND	ND
Sb-125	ND	ND	ND	ND	ND	ND	ND	ND	ND	ND	ND	ND	ND	ND	1.1
Gross β	41	18	ND (17)	ND (19)	ND (19)	ND (17)	ND (21)	ND (18)	1,400	76	ND (17)	ND (17)	ND (18)	ND (18)	ND (24)
H-3	3,200	2,200	1,800	1,800	1,800	1,600	1,600	1,500	1,700	1,700	1,700	1,400	1,500	1,500	1,100
Sr-90	8.3	ND (1.0)	0.25	ND (0.24)	ND (0.27)	Under measurement	-	-	-	-	-	-	-	-	-

* "ND" indicates that the measurement result is below the detection limit, and the detection limit of each nuclide is provided in parentheses.
 *1 As of γ nuclide measurement, the amount is lower than true value since the high BG is in use.

Groundwater observation hole No.3-1 (Bq/L) * Observation hole where sampling could not be performed due to the ground improvement construction

Sampling date	2013/7/23	2013/7/25	2013/8/1	2013/8/2	2013/8/8	2013/8/16	2013/8/22
Sampling time	11:10 AM	3:15 PM	1:38 PM	3:45 PM	3:04 PM	12:21 PM	11:55 AM
Cs-134	1.1	1.2	1.1	1.0	1.2	0.67	0.68
Cs-137	2.2	2.2	2.6	2.3	2.0	1.8	1.2
Ru-106	ND	ND	ND	ND	ND	ND	ND
Mn-54	ND	ND	ND	ND	ND	ND	ND
Co-60	ND	ND	ND	ND	ND	ND	ND
Sb-125	ND	ND	ND	ND	ND	ND	ND
Gross β	ND (19)	ND (18)	180	ND (18)	25	ND (20)	55
H-3	290	310	460	370	430	370	240
Sr-90	Under measurement	-	-	-	-	-	-

* "ND" indicates that the measurement result is below the detection limit, and the detection limit of each nuclide is provided in parentheses.

Groundwater observation hole No.3-4 (Bq/L)

Sampling date	2013/9/12	2013/9/18	2013/9/25	2013/10/2	2013/10/9	2013/10/17	2013/10/23	2013/10/30	2013/11/6	2013/11/13	2013/11/20	2013/11/27	2013/12/4
Sampling time	1:20 PM	10:16 AM	1:03 PM	11:12 AM	10:55 AM	11:40 AM	11:35 AM	11:19 AM	10:50 AM	10:50 AM	12:57 PM	11:14 AM	10:48 AM
Cs-134	0.52	0.72	1.0	0.68	0.66	0.96	1.0	1.8	1.4	1.5	1.3	1.7	1.1
Cs-137	1.3	1.8	1.1	1.3	1.9	2.2	2.3	3.8	3.6	3.6	3.0	4.3	3.4
Ru-106	ND	ND	ND	ND	ND	ND	ND	ND	ND	ND	ND	ND	ND
Mn-54	ND	ND	ND	ND	ND	ND	ND	0.54	0.54	ND	ND	ND	ND
Co-60	ND	ND	ND	ND	ND	ND	ND	ND	ND	ND	ND	ND	ND
Sb-125	ND	ND	ND	ND	ND	ND	ND	ND	ND	ND	ND	ND	ND
Gross β	ND (17)	ND (18)	ND (18)	ND (19)	ND (18)	ND (15)	ND (17)	ND (17)	ND (18)	ND (17)	ND (21)	ND (18)	ND (18)
H-3	ND (110)	170	130	160	ND (120)	ND (130)	ND (120)	ND (130)	ND (120)	ND (120)	ND (120)	ND (120)	Under measurement
Sr-90	Under measurement	-	-	-	-	-	-	-	-	-	-	-	-

* "ND" indicates that the measurement result is below the detection limit, and the detection limit of each nuclide is provided in parentheses.

Groundwater observation hole No.3-5 (Bq/L)

Sampling date	2013/11/23	2013/11/27
Sampling time	10:35 AM	11:36 AM
Cs-134	-	-
Cs-137	-	-
Ru-106	-	-
Mn-54	-	-
Co-60	-	-
Sb-125	-	-
Gross β	22'	35'
H-3	ND (120)	Under measurement
Sr-90	-	-

* "ND" indicates that the measurement result is below the detection limit, and the detection limit of each nuclide is provided in parentheses.

* Since the water of No.3-5 obtained on November 23 and 27 was highly turbid, only chloride, Gross β and tritium were analyzed as a reference.