

# The seawall area at Fukushima Daiichi NPS

<Reference>  
December 4, 2013  
Tokyo Electric Power Company

## Movement in groundwater (Between Unit 1 and 2: From Nov. 3 to Dec. 3)

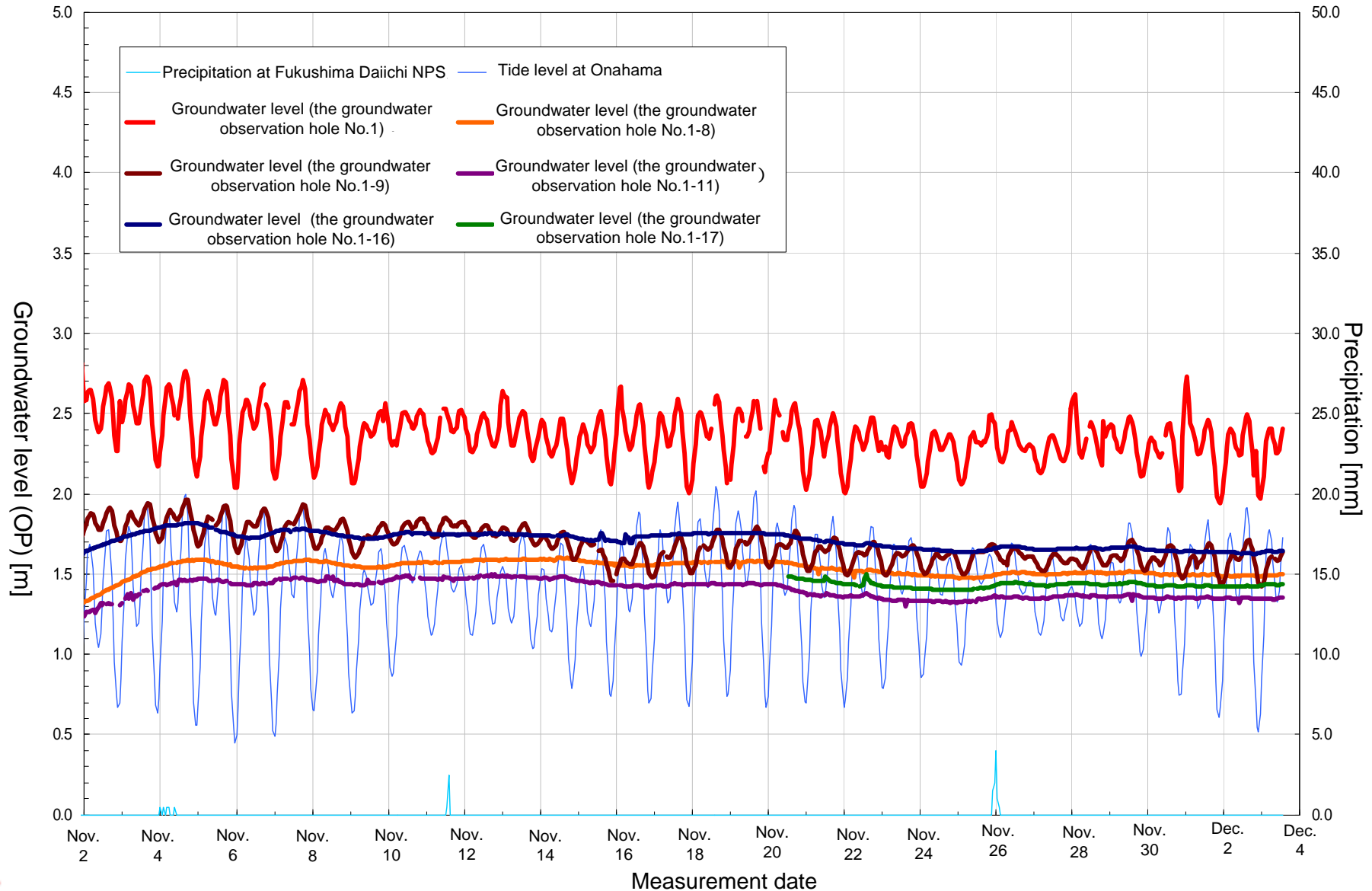

# Progress in the ground improvement work between Unit 1 and 2 (As of in the morning on Dec. 4)

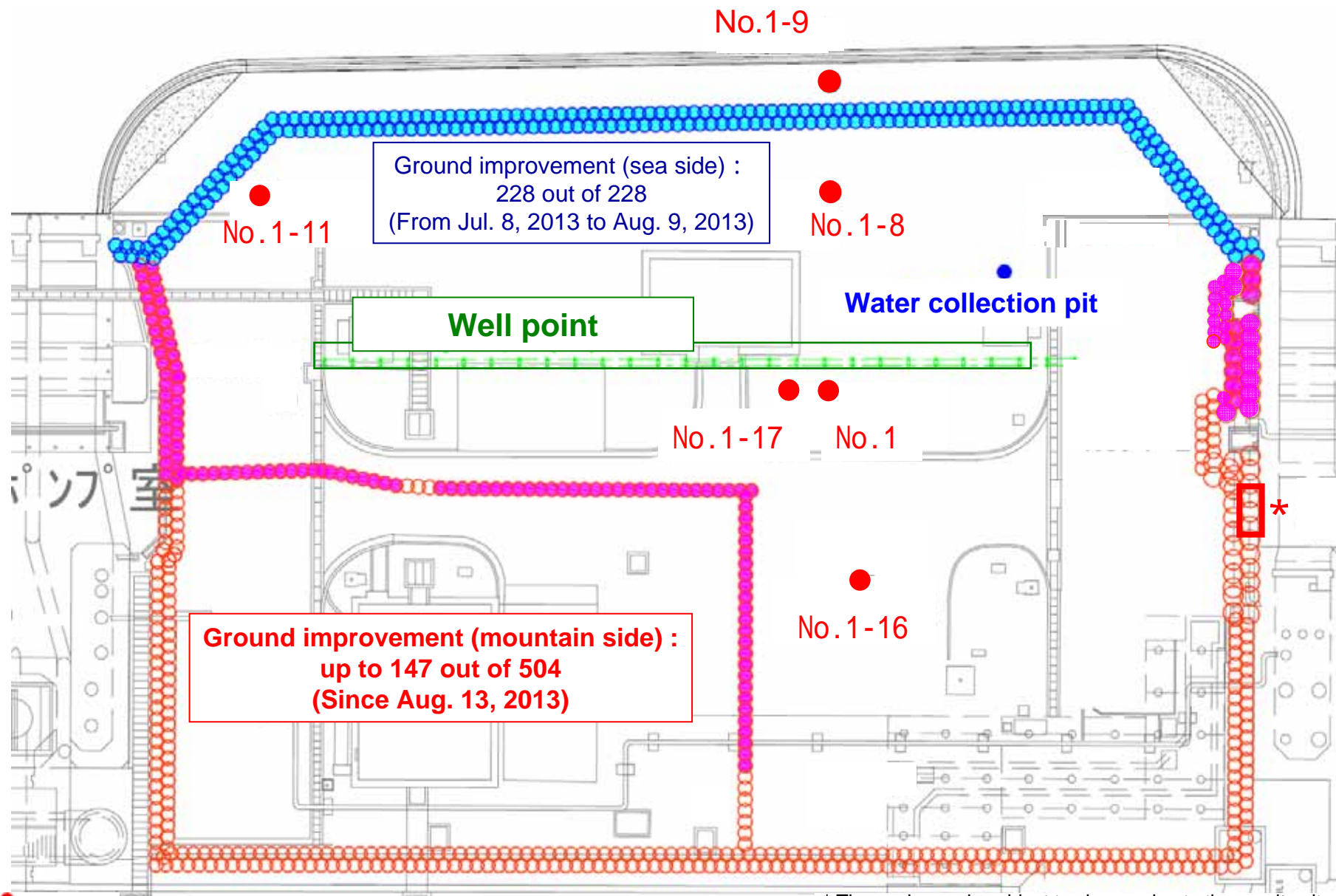

\* The work area is subject to change due to the on-site situation.

# Movement in groundwater (Between Unit 2 and 3: From Nov. 3 to Dec. 3)

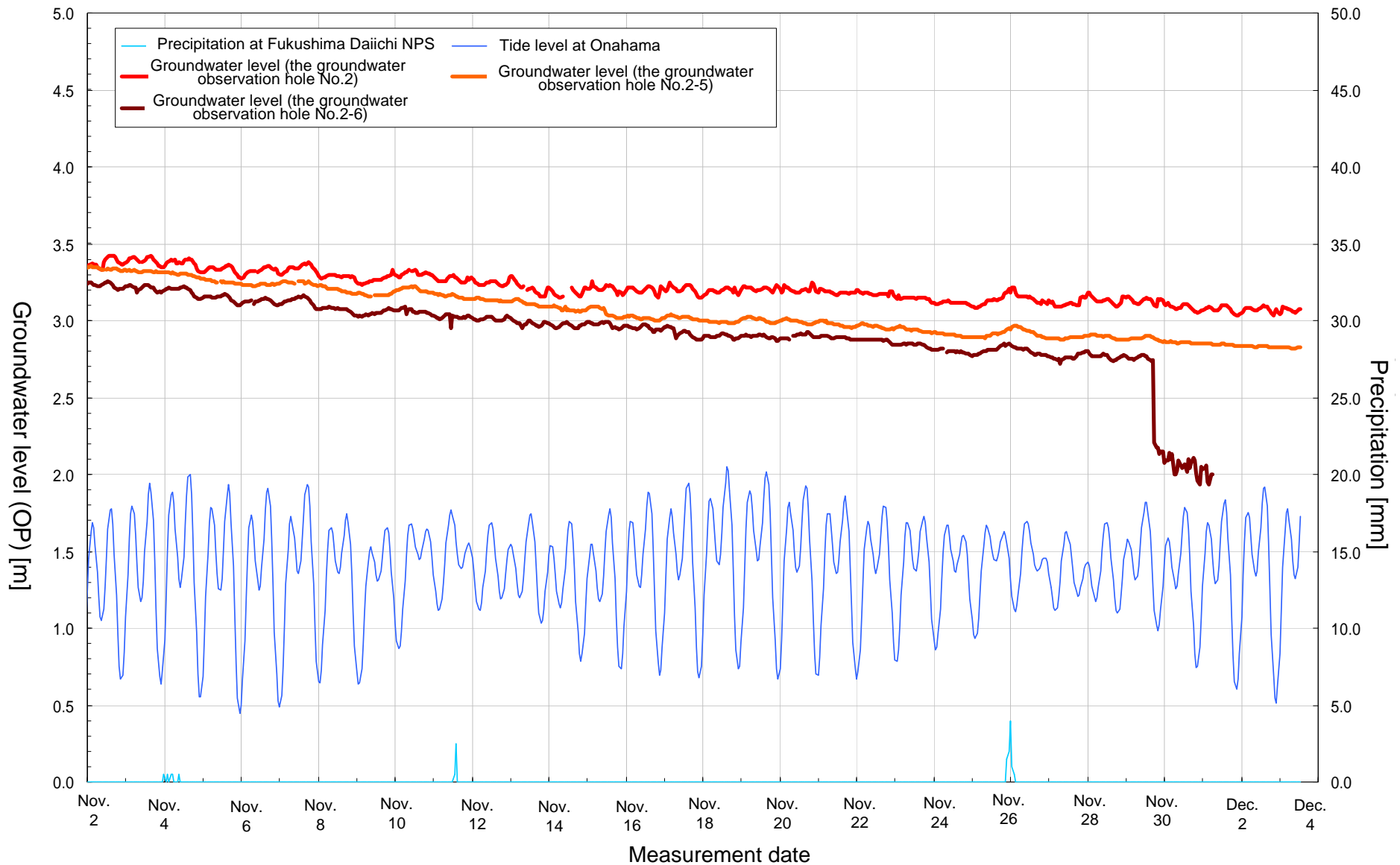

\*As for the water level at the groundwater level observation hole No.2-6, the water gauge was replaced on December 3 because it was suspected out of order.

\*Automatic measurement through a water level indication

# Progress in the ground improvement work between Unit 2 and 3 (As of in the morning on Dec. 4)

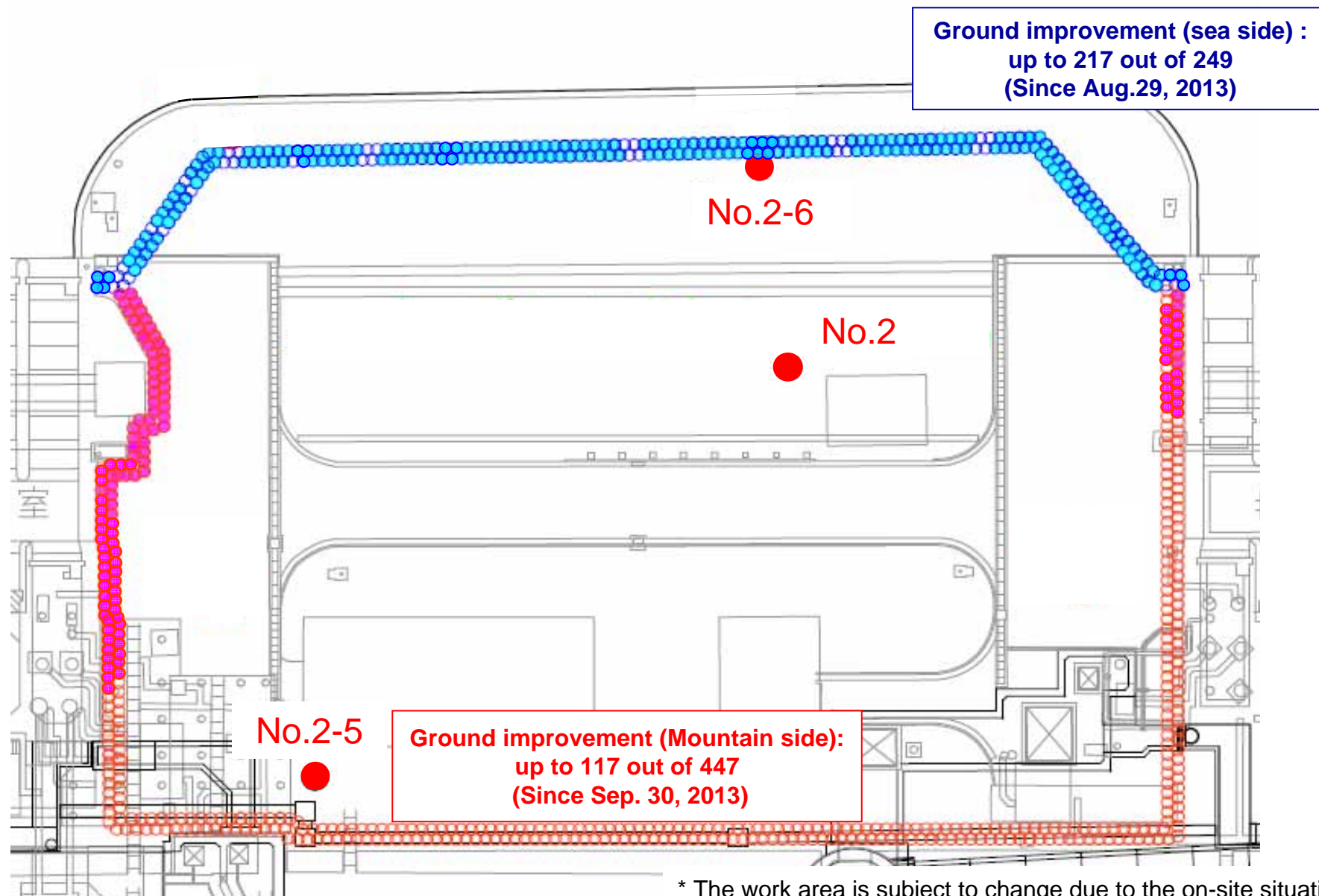

\* The work area is subject to change due to the on-site situation.

# Movement in groundwater (Between Unit 3 and 4: From Nov. 3 to Dec. 3)

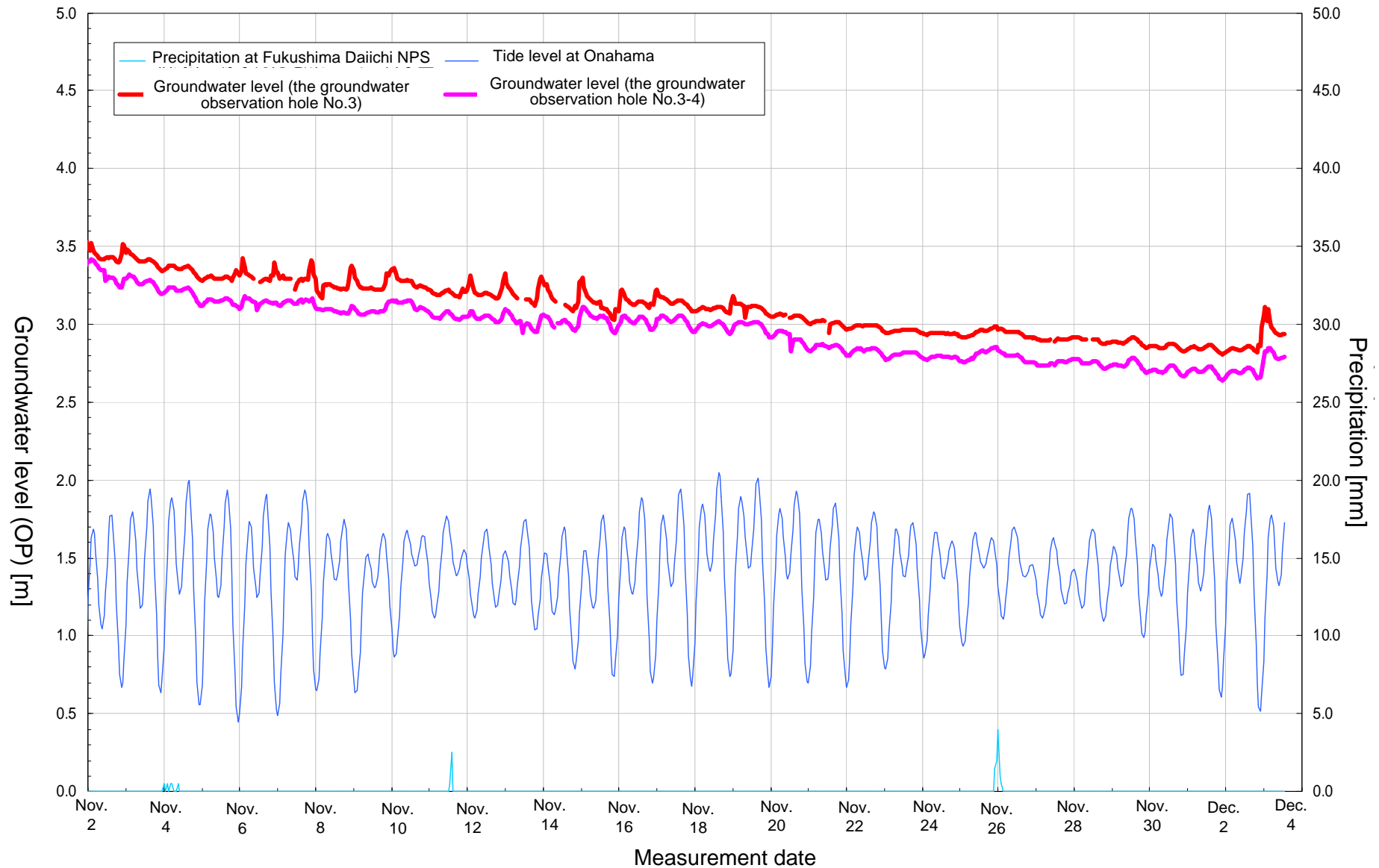



## Progress in the ground improvement work between Unit 3 and 4 (As of in the morning on Dec. 4)

Ground improvement (sea side):  
up to 38 out of 132  
(Since Aug. 23, 2013)

Ground improvement (mountain side):  
up to 36 out of 273  
(Since Oct. 19, 2013)

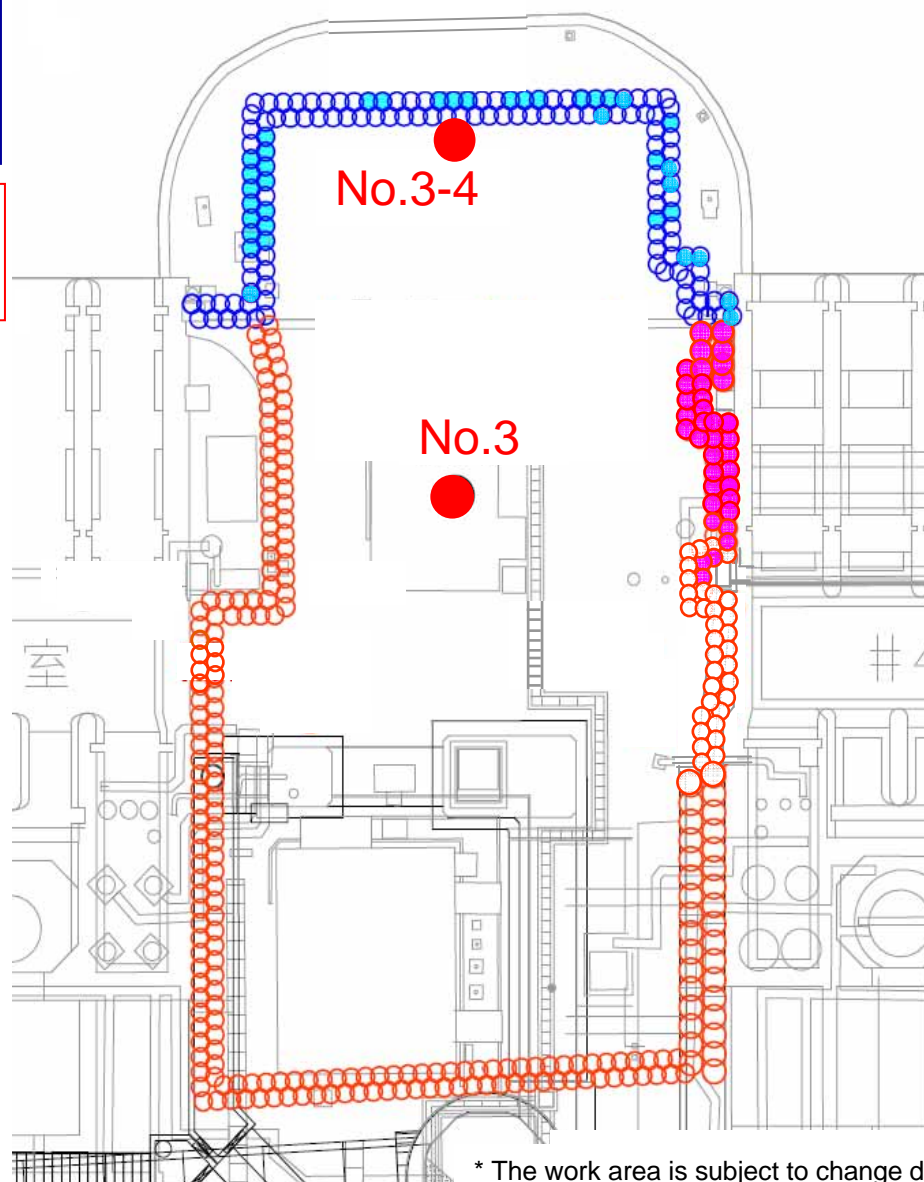

\* The work area is subject to change due to the on-site situation.