

The seawall area at Fukushima Daiichi NPS

<Reference>
 November 11, 2013
 Tokyo Electric Power Company

Movement in groundwater (Between Unit 1 and 2: From Oct. 9 to Nov. 9)

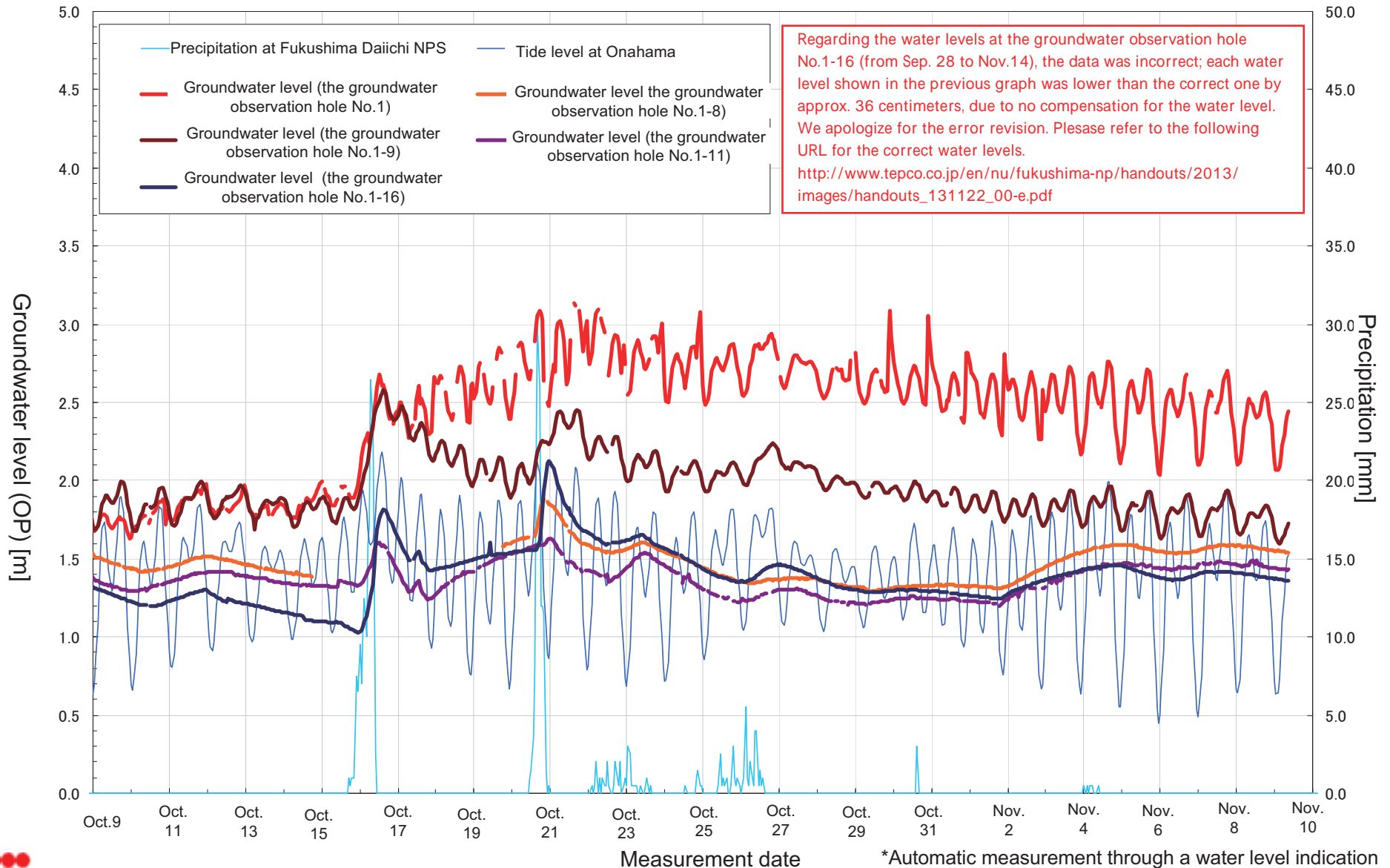

Progress in the ground improvement work between Unit 1 and 2 (As of in the morning on November 11)

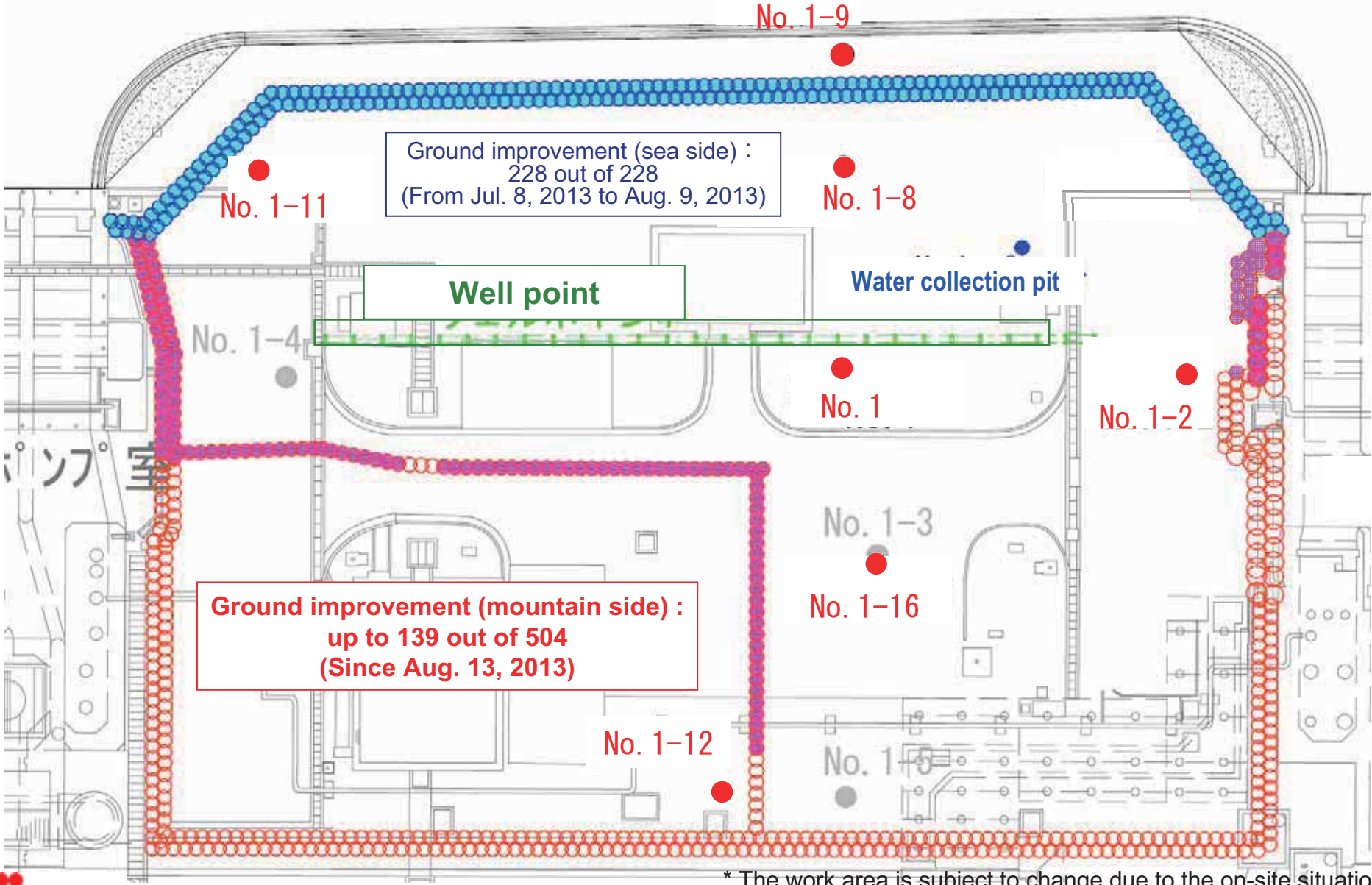

* The work area is subject to change due to the on-site situation.

Movement in groundwater (Between Unit 2 and 3: From Oct. 9 to Nov. 9)

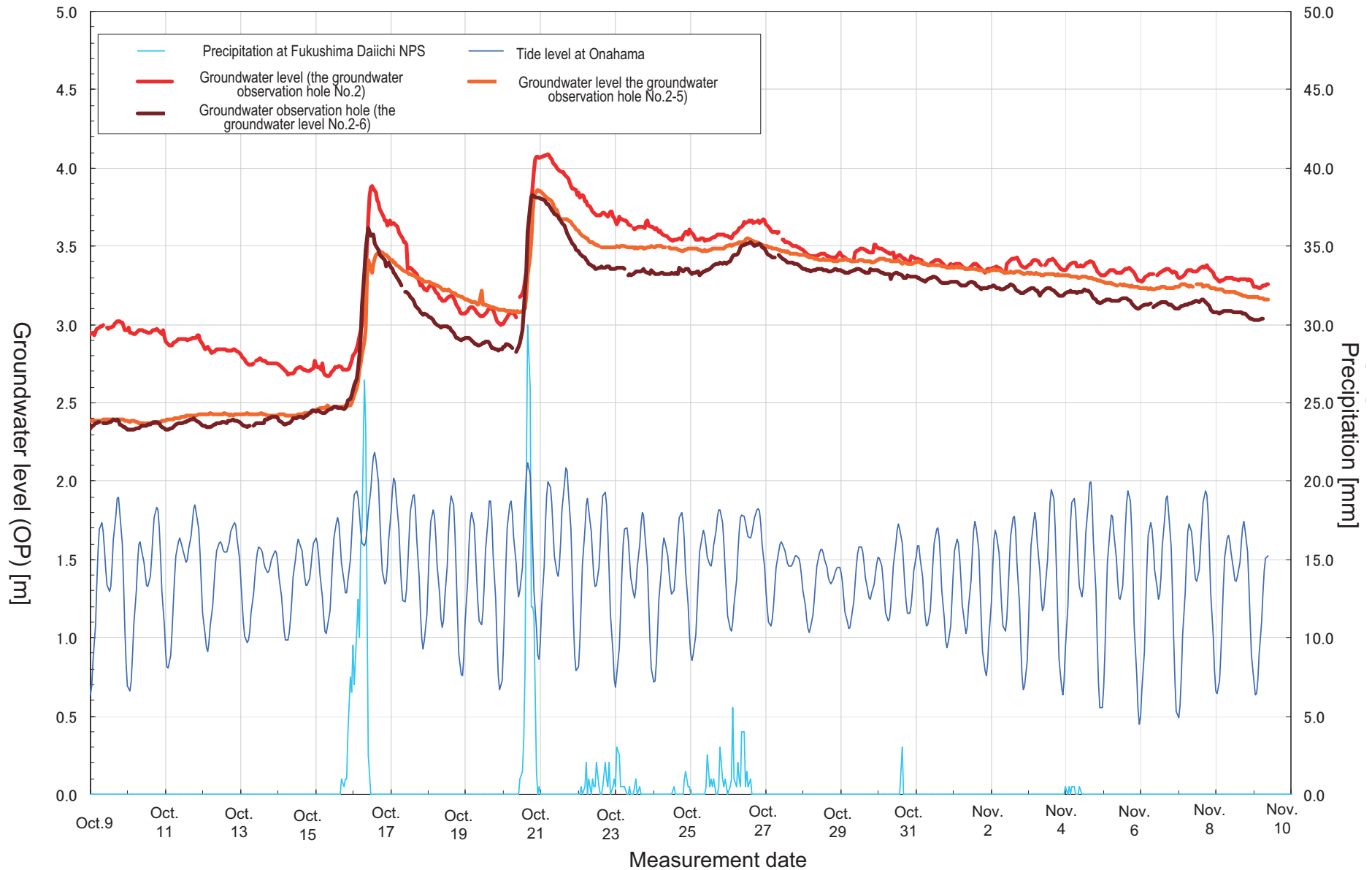

*Automatic measurement through a water level indication

Progress in the ground improvement work between Unit 2 and 3 (As of in the morning on November 11)

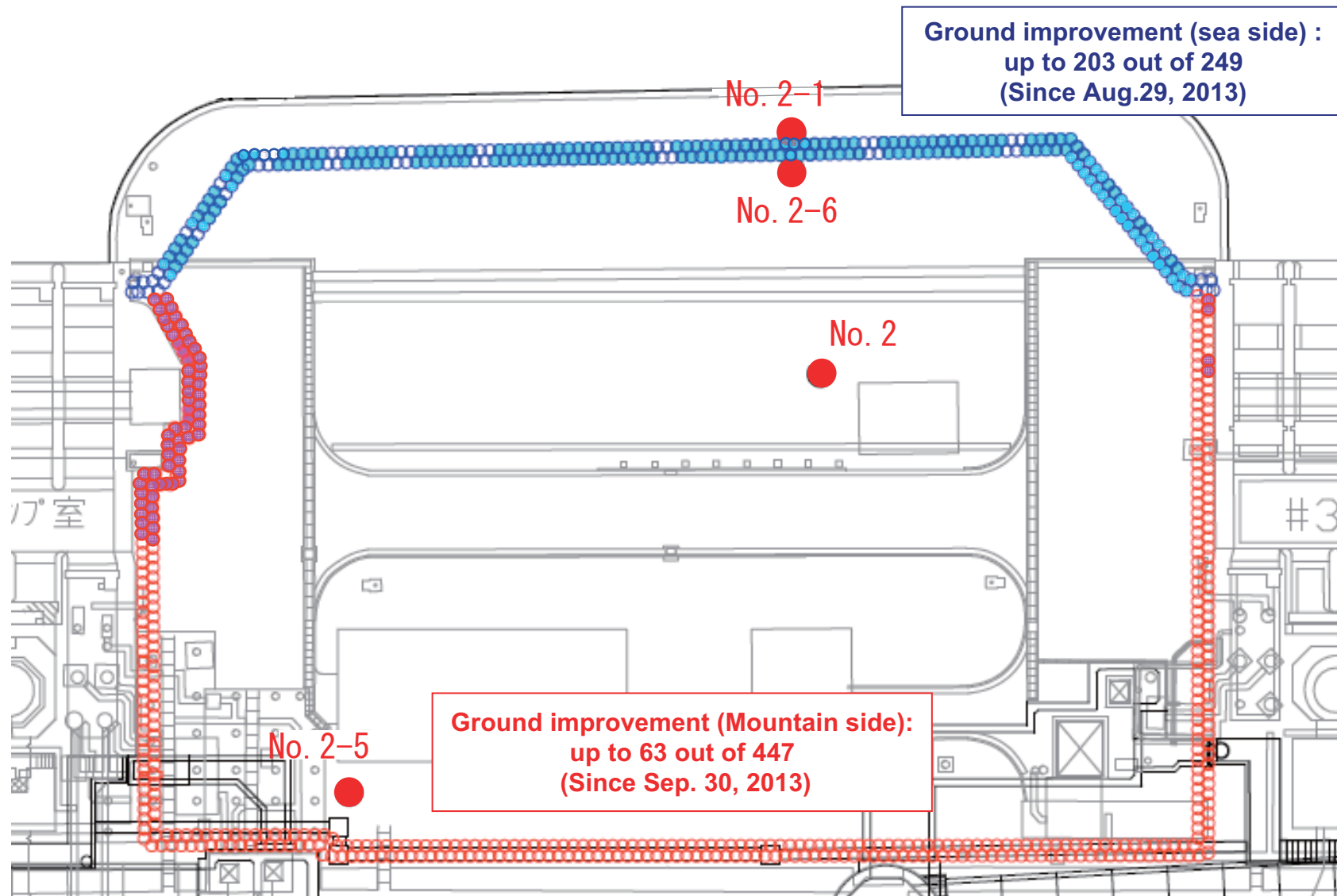

* The work area is subject to change due to the on-site situation.

Movement in groundwater (Between Unit 3 and 4: From Oct. 9 to Nov. 9)

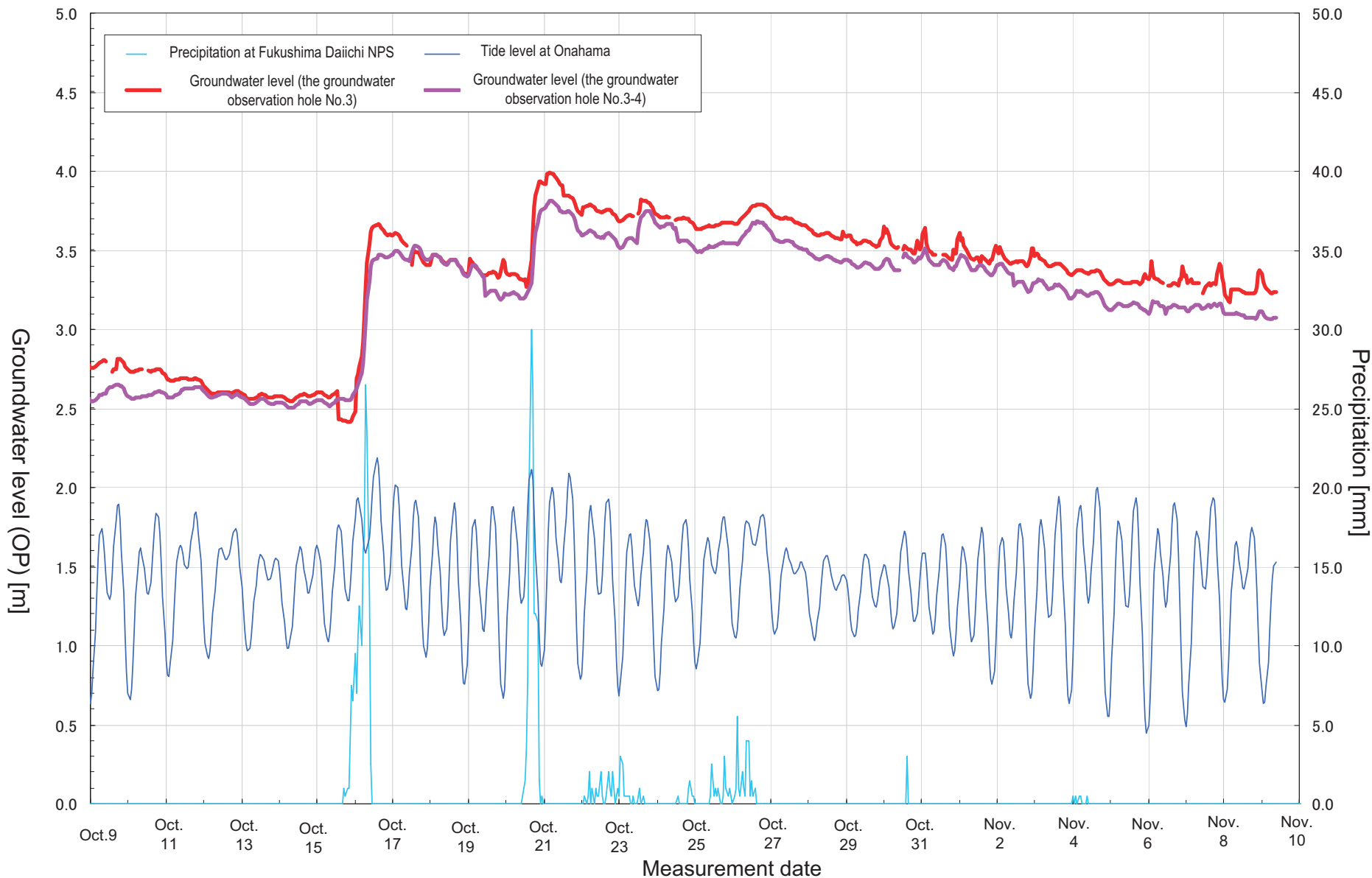

*Automatic measurement through a water level indication

Progress in the ground improvement work between Unit 3 and 4 (As of in the morning on November 11)

Ground improvement (sea side):
up to 30 out of 132
(Since Aug. 23, 2013)

Ground improvement (mountain side):
up to 22 out of 273
(Since Oct. 19, 2013)

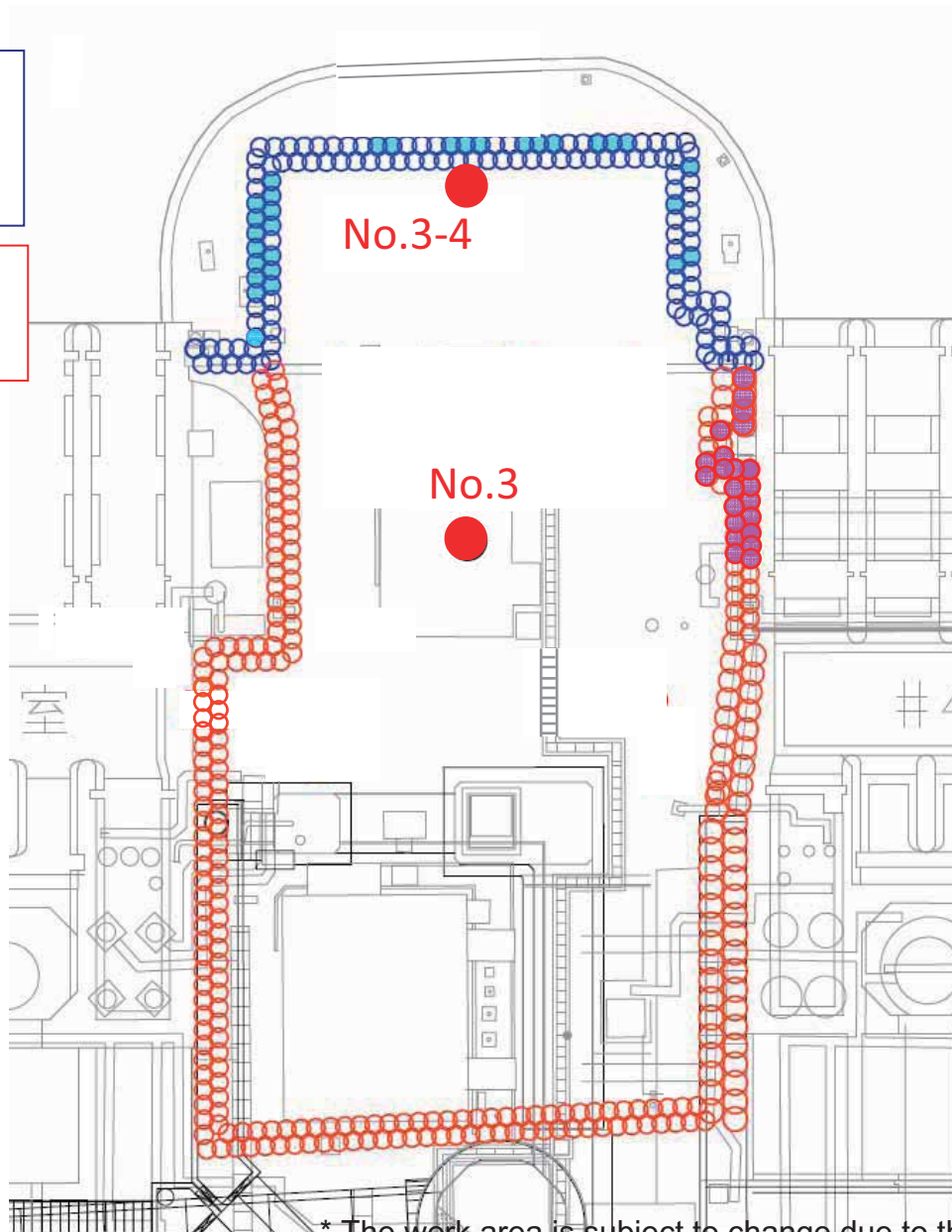

* The work area is subject to change due to the on-site situation.