

Completion of Water Stop Work at the Location Where Water Inflow into Unit 3 Radioactive Waste Underground Storage Facility Building was Found at Fukushima Daiichi Nuclear Power Station

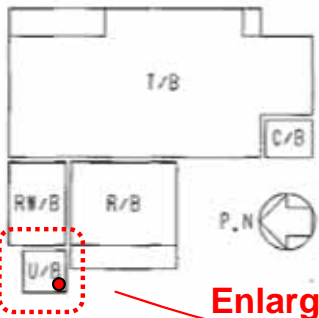

Enlarged

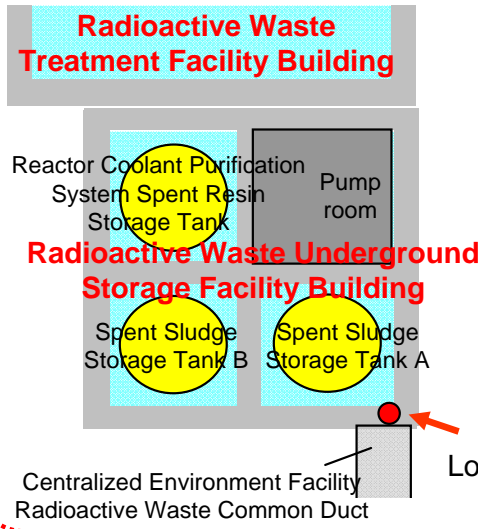

2012

- June 26: Work started
- November 16: Temporary water stop dam installation started
- November 21: Pipe cutting/removal started
- December 17: Water stop work started
- 2013
- March 1: Water stop work completed

Location of water inflow:
 Unit 3 Radioactive
 Waste Underground
 Storage Facility Building

Location of water inflow

[Current conditions]



Pipe penetration area where water inflow was found

(Photo taken on May 29, 2012 by TEPCO)



Pipe penetration area before water stop work (duct side)

(Photo taken on July 2, 2012 by TEPCO)



Pipe penetration area after water stop work implementation (duct side)

(Photo taken on December 19, 2012 by a cooperative company)

[Water stop method]

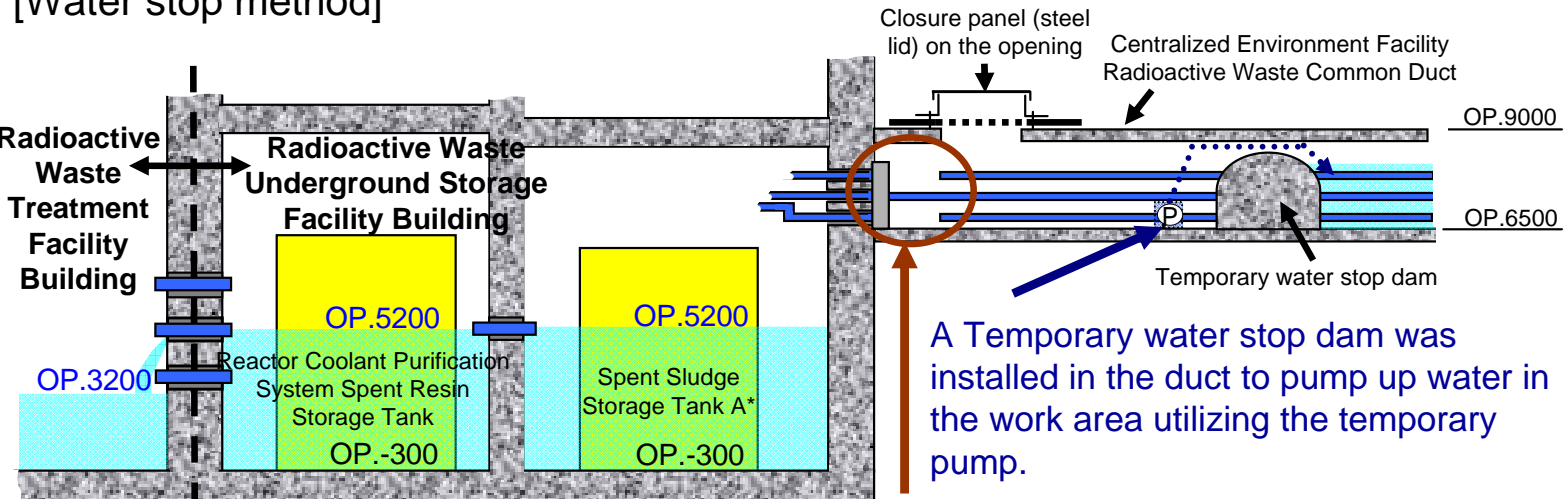

A Temporary water stop dam was installed in the duct to pump up water in the work area utilizing the temporary pump.

* The reactor coolant purification system spent resin storage tank is connected to the spent sludge storage tank B side.

- Some of the pipes have been cut.
- Water stop work has been implemented near the piping (application of waterproof material).