

### Detailed Analysis Results in the Port of Fukushima Daiichi NPS, around Discharge Channel and Bank Protection (Sampling Locations of Underground Water Obtained at Bank Protection)

● Sampling locations of underground water obtained at bank

East seawall break

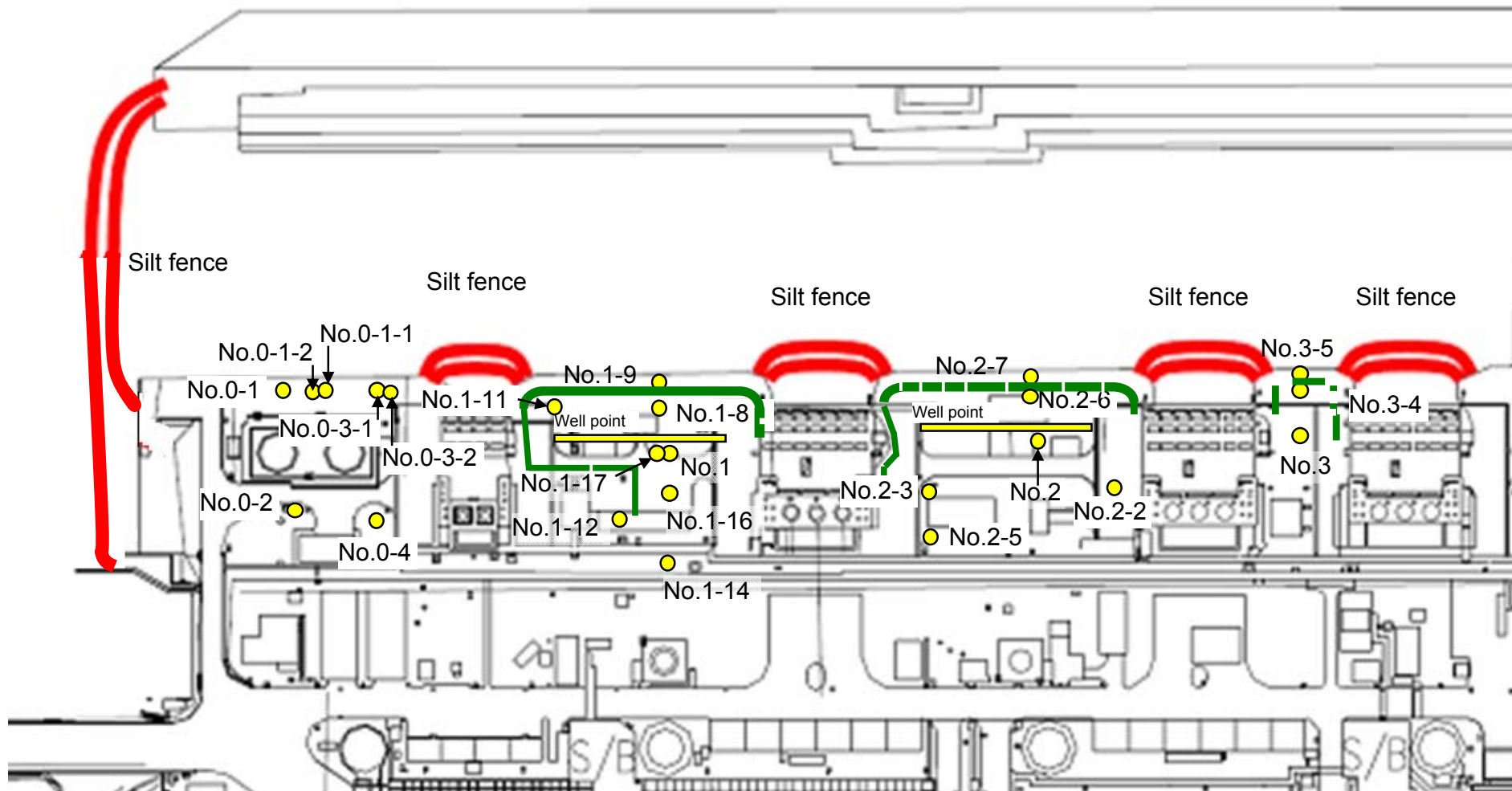

— : Location where ground improvement construction was completed, or being implemented (as of December 27)

## Detailed Analysis Results in the Port of Fukushima Daiichi NPS, around Discharge Channel and Bank Protection (1/4) Underground Water Obtained at Bank Protection

Unit: Bq/L (exclude chloride)

	Underground water observation hole No.0-1	Underground water observation hole No.0-1-1	Underground water observation hole No.0-1-2	Underground water observation hole No.0-2	Underground water observation hole No.0-3-1	Underground water observation hole No.0-3-2	Underground water observation hole No.0-4	Underground water observation hole No.1	Underground water observation hole No.1-8	Underground water observation hole No.1-9	Underground water observation hole No.1-11	Underground water observation hole No.1-12	Underground water observation hole No.1-14	Underground water observation hole No.1-16
Date of sampling	Jan 12, 2014		Jan 12, 2014	Jan 12, 2014	Jan 12, 2014	Jan 14, 2014	Jan 12, 2014	Jan 13, 2014	Jan 13, 2014	Jan 14, 2014	Jan 13, 2014	Jan 13, 2014	Jan 13, 2014	Jan 13, 2014
Time of sampling	11:48 AM		11:10 AM	9:15 AM	10:50 AM	12:00 PM	10:05 AM	9:20 AM	9:38 AM	7:00 AM	10:02 AM	10:15 AM	10:30 AM	10:40 AM
Chloride (unit: ppm)	-		-	-	-	-	-	-	-	340	-	-	-	-
Cs-134 (Approx. 2 years)	6.8		ND(0.35)	ND(0.49)	ND(0.39)	0.82	ND(0.44)	ND(0.45)	31	11	1.1	4.9	0.79	ND(2.8)
Cs-137 (Approx.30 years)	15		ND(0.44)	2.20	ND(0.45)	2.1	1.4	ND(0.45)	71	28	2.8	12	1.9	2.5
The other γ	Mn-54 (Approx. 310 days)	ND	ND	ND	ND	0.36	ND	ND	7.0	ND	ND	ND	ND	ND
	Co-60 (Approx. 5 years)	ND	ND	ND	ND	ND	ND	ND	0.67	ND	ND	ND	ND	ND
	Ru-106 (Approx. 370 days)	ND	ND	ND	ND	ND	ND	3.7	ND	ND	ND	ND	ND	ND
	Sb-125 (Approx. 3 years)	ND	ND	ND	ND	ND	ND	ND	ND	ND	ND	ND	ND	7.3
Gross β	110		ND(19)	ND(19)	ND(19)	ND(15)	ND(19)	640	35,000	140	57	110	360	2,400,000
H-3 (Approx. 12 years)	37,000		50,000	4,700	ND(110)	73,000	46,000	250,000	10,000	420	18,000	32,000	10,000	14,000
Sr-90 (Approx. 29 years)	-		-	-	-	-	-	-	Under analysis	-	-	-	Under analysis	-

	Underground water observation hole No.1-17	Groundwater pumped up from the well point (between Unit 1 and 2)	Underground water observation hole No.2	Underground water observation hole No.2-2	Underground water observation hole No.2-3	Underground water observation hole No.2-5	Underground water observation hole No.2-6	Underground water observation hole No.2-7	Groundwater pumped up from the well point (between Unit 2 and 3)	Underground water observation hole No.3	Underground water observation hole No.3-4	Underground water observation hole No.3-5
Date of sampling	Jan 13, 2014	Jan 13, 2014					Jan 14, 2014					
Time of sampling	9:40 AM	9:20 AM					9:06 AM					
Chloride (unit: ppm)	-	-					-					
Cs-134 (Approx. 2 years)	ND(0.53)	7.2					ND(0.34)					
Cs-137 (Approx.30 years)	ND(0.44)	17					ND(0.52)					
The other γ	Mn-54 (Approx. 310 days)	ND	0.72				ND					
	Co-60 (Approx. 5 years)	0.48	ND				ND					
	Ru-106 (Approx. 370 days)	ND	7.0				ND					
	Sb-125 (Approx. 3 years)	1.2	ND				ND					
Gross β	120	170,000					2,200					
H-3 (Approx. 12 years)	29,000	110,000					1,000					
Sr-90 (Approx. 29 years)	-	-					-					

\* Data announced this time is provided in a thick-frame. The other data was announced on January 13, 14 and 15.

\*\* "ND" indicates that the measurement result is below the detection limit, and the detection limit of each nuclide is provided in parentheses.

\*\* "-" indicates that the measurement was out of range.

## Detailed Analysis Results in the Port of Fukushima Daiichi NPS, around Discharge Channel and Bank Protection (2/4) Underground Water Obtained at Bank Protection

Unit: Bq/L (exclude chloride)

	Underground water observation hole No.0-1	Underground water observation hole No.0-1-1	Underground water observation hole No.0-1-2	Underground water observation hole No.0-2	Underground water observation hole No.0-3-1	Underground water observation hole No.0-3-2	Underground water observation hole No.0-4	Underground water observation hole No.1	Underground water observation hole No.1-8	Underground water observation hole No.1-9	Underground water observation hole No.1-11	Underground water observation hole No.1-12	Underground water observation hole No.1-14	Underground water observation hole No.1-16
Date of sampling						Jan 16, 2014		Jan 16, 2014		Jan 16, 2014	Jan 16, 2014	Jan 16, 2014	Jan 16, 2014	Jan 16, 2014
Time of sampling						12:00 PM		9:35 AM		6:56 AM	10:15 AM	9:26 AM	9:39 AM	9:55 AM
Chloride (unit: ppm)						-		-		250	-	-	-	-
Cs-134 (Approx. 2 years)						ND(0.38)		ND(0.47)		2.9	0.87	4.7	ND(0.35)	ND(2.0)
Cs-137 (Approx.30 years)						ND(0.52)		0.87		6.8	1.4	11	1.2	ND(2.1)
The other y	Mn-54 (Approx. 310 days)					0.40		ND		ND	ND	ND	ND	ND
	Ru-106 (Approx. 370 days)					ND		3.5		ND	ND	ND	ND	ND
Gross β					ND(17)		520		96	29	120	410	2,700,000	
H-3 (Approx. 12 years)						Under analysis		Under analysis		Under analysis	Under analysis	Under analysis	Under analysis	
Sr-90 (Approx. 29 years)						-		-		Under analysis	-	-	-	-

	Underground water observation hole No.1-17	Groundwater pumped up from the well point (between Unit 1 and 2)	Underground water observation hole No.2	Underground water observation hole No.2-2	Underground water observation hole No.2-3	Underground water observation hole No.2-5	Underground water observation hole No.2-6	Underground water observation hole No.2-7	Groundwater pumped up from the well point (between Unit 2 and 3)	Underground water observation hole No.3*	Underground water observation hole No.3-4	Underground water observation hole No.3-5
Date of sampling	Jan 16, 2014						Jan 16, 2014					
Time of sampling	9:58 AM						9:07 AM					
Chloride (unit: ppm)	-						-					
Cs-134 (Approx. 2 years)	ND(0.52)						ND(0.40)					
Cs-137 (Approx.30 years)	ND(0.49)						0.60					
The other y	Ru-106 (Approx. 370 days)	3.0					ND					
	Sb-125 (Approx. 3 years)	1.2					ND					
Gross β	68						2,200					
H-3 (Approx. 12 years)	Under analysis						Under analysis					
Sr-90 (Approx. 29 years)	-						-					

\* "ND" indicates that the measurement result is below the detection limit, and the detection limit of each nuclide is provided in parentheses.

\* "-" indicates that the measurement was out of range.

# Detailed Analysis Results in the Port of Fukushima Daiichi NPS, around Discharge Channel and Bank Protection (Sampling Locations of Seawater)



## Detailed Analysis Results in the Port of Fukushima Daiichi NPS, around Discharge Channel and Bank Protection (3/4) Seawater

Unit: Bq/L

	1F, North side of Unit 5,6 discharge channel	1F, In front of Unit 6 water intake channel	1F, In front of shallow draft quay	1F, North side of Unit 1-4 water intake channel	1F, North side of Unit 1-4 water intake channel (north side of East Seawall Break)	1F, Unit 1 Screen (Inside the Silt Fence)	1F, Between the water intake channel of Unit 1 and Unit 2 (surface layer)	1F, Between the water intake channel of Unit 1 and Unit 2 (lower layer)	1F, Unit 2 Screen (Inside the Silt Fence)	1F, Between the water intake channel of Unit 2 and Unit 3	1F, Unit 3 Screen (Inside the Silt Fence)	1F, Between the water intake channel of Unit 3 and Unit 4	Density Limit Specified by the Reactor Regulation *	WHO Guidelines for drinking-water quality
Date of Sampling	Jan 13, 2014	Jan 13, 2014	Jan 13, 2014	Jan 14, 2014	Jan 13, 2014	Jan 13, 2014	Jan 14, 2014	Jan 14, 2014	Jan 13, 2014	Jan 13, 2014	Jan 13, 2014	Jan 13, 2014		
Time of sampling	6:30 AM	6:40 AM	6:19 AM	6:51 AM	6:53 AM	6:27 AM	6:56 AM	6:56 AM	6:31 AM	6:36 AM	6:41 AM	6:45 AM		
Cs-134(Approx. 2 years)	ND(0.81)	ND(3.0)	2.4	21	5.3	16	17	15	15	9.6	11	8	60	10
Cs-137(Approx.30 years)	ND(0.82)	3.7	5.8	50	16	40	45	36	35	30	28	19	90	10
Gross β	11	19	33	270	46	230	300	140	230	140	110	85		
H-3 (Approx. 12 years)	ND(1.7)	7.3	7.7	770	ND(110)	620	790	260	640	300	200	150	60,000	10,000
Sr-90 (Approx. 29 years)	Under analysis	-	Under analysis	-	Under analysis	Under analysis	-	-	Under analysis	Under analysis	Under analysis	Under analysis	30	10

Unit: Bq/L

	1F, Unit 4 Screen (Inside the Silt Fence)	1F, Around the south discharge channel	1F, Port entrance	1F, East side in the port	1F, West side in the port	1F, North side in the port	1F, South side in the port	North side of the north breakwater	Northeast side of the port entrance	East side of the port entrance	Southeast side of the port entrance	South side of the south breakwater	Density Limit Specified by the Reactor Regulation *	WHO Guidelines for drinking-water quality
Date of Sampling	Jan 13, 2014	Jan 13, 2014												
Time of sampling	6:44 AM	5:50 AM												
Cs-134(Approx. 2 years)	8.6	ND(0.73)											60	10
Cs-137(Approx.30 years)	22	ND(0.59)											90	10
Gross β	100	15												
H-3 (Approx. 12 years)	130	ND(1.7)											60,000	10,000
Sr-90 (Approx. 29 years)	Under analysis	Under analysis											30	10

\* Data announced this time is provided in a thick-frame. The other data was announced on January 14 and 15.

\* "ND" indicates that the measurement result is below the detection limit, and the detection limit of each nuclide is provided in parentheses.

\* "-" indicates that the measurement was out of range.

\* Density Limit Specified by the Rule for the Installation, Operation, etc. of Commercial Nuclear Power Reactors (the density limit in the water outside the surrounding monitored areas is provided in section 6 of Appendix 2 [the amount is converted from Bq/cm<sup>3</sup> to Bq/L]).

**Detailed Analysis Results in the Port of Fukushima Daiichi NPS, around Discharge Channel and Bank Protection (4/4)  
Seawater**

Unit: Bq/L

	1F, North side of Unit 5,6 discharge channel	1F, In front of Unit 6 water intake channel	1F, In front of shallow draft quay	1F, North side of Unit 1-4 water intake channel	1F, North side of Unit 1-4 water intake channel (north side of East Seawall Break)	1F, Unit 1 Screen (Inside the Silt Fence)	1F, Between the water intake channel of Unit 1 and Unit 2 (surface layer)	1F, Between the water intake channel of Unit 1 and Unit 2 (lower layer)	1F, Unit 2 Screen (Inside the Silt Fence)	1F, Between the water intake channel of Unit 2 and Unit 3	1F, Unit 3 Screen (Inside the Silt Fence)	1F, Between the water intake channel of Unit 3 and Unit 4	Density Limit Specified by the Reactor Regulation *	WHO Guidelines for drinking-water quality
Date of Sampling	/	/	/	Jan 16, 2014	/	/	Jan 16, 2014	Jan 16, 2014	/	/	/	/		
Time of sampling	/	/	/	6:48 AM	/	/	6:52 AM	6:52 AM	/	/	/	/		
Cs-134(Approx. 2 years)	/	/	/	20	/	/	21	15	/	/	/	/	60	10
Cs-137(Approx.30 years)	/	/	/	49	/	/	49	39	/	/	/	/	90	10
Gross β	/	/	/	430	/	/	400	130	/	/	/	/		
H-3 (Approx. 12 years)	/	/	/	Under analysis	/	/	Under analysis	Under analysis	/	/	/	/	60,000	10,000
Sr-90 (Approx. 29 years)	/	/	/	-	/	/	-	-	/	/	/	/	30	10

Unit: Bq/L

	1F, Unit 4 Screen (Inside the Silt Fence)	1F, Around the south discharge channel	1F, Port entrance	1F, East side in the port	1F, West side in the port	1F, North side in the port	1F, South side in the port	North side of the north breakwater	Northeast side of the port entrance	East side of the port entrance	Southeast side of the port entrance	South side of the south breakwater	Density Limit Specified by the Reactor Regulation *	WHO Guidelines for drinking-water quality
Date of Sampling	/	/	/	/	/	/	/	/	/	/	/	/		
Time of sampling	/	/	/	/	/	/	/	/	/	/	/	/		
Cs-134(Approx. 2 years)	/	/	/	/	/	/	/	/	/	/	/	/	60	10
Cs-137(Approx.30 years)	/	/	/	/	/	/	/	/	/	/	/	/	90	10
Gross β	/	/	/	/	/	/	/	/	/	/	/	/		
H-3 (Approx. 12 years)	/	/	/	/	/	/	/	/	/	/	/	/	60,000	10,000
Sr-90 (Approx. 29 years)	/	/	/	/	/	/	/	/	/	/	/	/	30	10

\* "ND" indicates that the measurement result is below the detection limit, and the detection limit of each nuclide is provided in parentheses.

\* "-" indicates that the measurement was out of range.

\* Density Limit Specified by the Rule for the Installation, Operation, etc. of Commercial Nuclear Power Reactors (the density limit in the water outside the surrounding monitored areas is provided in section 6 of Appendix 2 [the amount is converted from Bq/cm<sup>3</sup> to Bq/L]).

<Reference> The Highest Dose Until the Previous Measurement (Groundwater Obtained at Bank Protection)

Unit: Bq/L

	Groundwater observation hole No.0-1	Groundwater observation hole No.0-1-1	Groundwater observation hole No.0-1-2	Groundwater observation hole No.0-2	Groundwater observation hole No.0-3-1	Groundwater observation hole No.0-3-2	Groundwater observation hole No.0-4	Groundwater observation hole No.1	Groundwater observation hole No.1-1 <sup>*</sup>	Groundwater observation hole No.1-2 <sup>*</sup>	Groundwater observation hole No.1-3 <sup>*</sup>	Groundwater observation hole No.1-4 <sup>*</sup>	Groundwater observation hole No.1-5 <sup>*</sup>
Cs-134 (Approx. 2 years)	7.6 [12/15]	ND	ND	0.61 [10/13]	0.44 [11/24]	0.82 <1/14>	ND	13 [8/29]	1.9 [7/8]	11,000 [7/9]	10 [9/2]	1.5 [7/8]	310 [8/5]
Cs-137 (Approx.30 years)	17 [12/15] [12/29]	0.58 [12/7]	0.51 [11/17]	2.2 <1/12>	0.86 [11/20]	2.1 <1/14>	1.4 <1/12>	31 [8/29]	3.6 [7/8]	22,000 [7/9]	24 [9/2]	3.6 [7/8]	650 [8/5]
The other y	Ru-106 (Approx. 370 days)	ND	ND	ND	ND	ND	ND	26 [5/24]	7.9 [7/8]	160 [8/15]	17 [7/22] [8/8]	3.1 [8/8]	ND
	Mn-54 (Approx. 310 days)	ND	ND	ND	ND	0.40 <1/5>	ND	ND	1.0 [7/5]	62 [7/5]	ND	ND	ND
	Co-60 (Approx. 5 years)	ND	ND	ND	ND	ND	ND	0.50 [7/19]	ND	3.1 [7/8]	ND	ND	ND
	Sb-125 (Approx. 3 years)	ND	ND	ND	ND	ND	ND	1.7 [7/11]	ND	250 [7/15]	1.4 [7/12] [8/26]	ND	12 [8/8]
Gross β	300 [8/22]	21 [12/7]	21 [11/10]	87 [10/13]	ND	67 <sup>2</sup> [12/11]	29 [12/29]	1,900 [5/24]	4,400 [7/8]	900,000 [7/5] [7/9]	160,000 [8/12] [8/15]	380 [8/19]	56,000 [8/5]
H-3 (Approx. 12 years)	45,000 [8/29]	18,000 [12/7]	74,000 [12/15]	3,900 <1/5>	ND	70,000 [12/29]	36,000 <1/5>	500,000 [5/24] [6/7]	630,000 [7/8]	430,000 [9/16]	290,000 [7/12]	98,000 [7/11]	72,000 [8/15]
Sr-90(Approx. 29 years)	Under analysis	Under analysis	Under analysis	Under analysis	Under analysis	Under analysis	Under analysis	1,200 [6/7]	Under analysis	Under analysis	Under analysis	Under analysis	Under analysis

Unit: Bq/L

	Groundwater observation hole No.1-8	Groundwater observation hole No.1-9	Groundwater observation hole No.1-11	Groundwater observation hole No.1-12	Groundwater observation hole No.1-14	Groundwater observation hole No.1-16	Groundwater observation hole No.1-17	Groundwater pumped up from the well point (between Unit 1 and 2)
Cs-134 (Approx. 2 years)	47 [11/25]	170 [9/3]	1.1 <1/13>	74 [10/21]	1.2 [11/14]	3.1 <sup>2</sup> [12/13]	1.2 [12/5]	110 [9/23]
Cs-137 (Approx.30 years)	110 [11/25]	380 [9/3]	2.8 <1/13>	170 [10/21]	2.3 [11/21]	3.4 [10/10]	0.66 [12/12]	250 [9/23]
The other y	Ru-106 (Approx. 370 days)	ND	ND	5.4 [10/28]	ND	9.2 [10/28]	4.1 [12/12]	25 [9/2]
	Mn-54 (Approx. 310 days)	9.7 [12/16]	ND	ND	ND	ND	ND	0.83 [12/30]
	Co-60 (Approx. 5 years)	0.63 [12/23]	ND	ND	0.51 [10/24]	ND	0.9 [11/7]	0.61 [11/25]
	Sb-125 (Approx. 3 years)	ND	ND	ND	61 [10/21]	ND	11 [12/5]	2.1 [11/25]
Gross β	39,000 <1/6>	2,100 [11/17]	2,300 [12/26]	730 [10/21]	360 <1/13>	2,400,000 <1/13>	130 [12/2] [12/23]	700,000 [9/23]
H-3 (Approx. 12 years)	12,000 <1/6>	860 [11/14]	85,000 [9/13]	440,000 [10/31]	11,000 [11/25]	43,000 [9/26]	30,000 <1/9>	460,000 [8/19]
Sr-90(Approx. 29 years)	Under analysis	Under analysis	Under analysis	Under analysis [10/21]	Under analysis	Under analysis	Under analysis	-

Unit: Bq/L

	Groundwater observation hole No.2	Groundwater observation hole No.2-1 <sup>*</sup>	Groundwater observation hole No.2-2	Groundwater observation hole No.2-3	Groundwater observation hole No.2-5 <sup>*1</sup>	Groundwater observation hole No.2-6	Groundwater observation hole No.2-7	Groundwater pumped up from the well point (between Unit 2 and 3)	Groundwater observation hole No.3	Groundwater observation hole No.3-1 <sup>*</sup>	Groundwater observation hole No.3-4	Groundwater observation hole No.3-5
Cs-134 (Approx. 2 years)	0.50 [7/9]	0.66 [9/1]	13 <1/15>	0.84 <1/5>	13 <1/8>	0.56 [10/30]	1.5 <1/12>	1.1 [12/12]	3.5 [7/25]	1.2 [7/25] [8/8]	1.9 <1/8>	64 <1/15>
Cs-137 (Approx.30 years)	1.2 [7/11] [8/1]	1.1 [8/29] [9/1]	31 <1/15>	2.6 <1/5>	30 <1/8>	0.61 [10/13]	3.6 <1/12>	2.4 [12/7]	5.9 [8/8]	2.6 [8/1]	4.3 [11/27]	170 <1/15>
The other y	Ru-106 (Approx. 370 days)	ND	ND	ND	ND	ND	ND	ND	ND	ND	ND	-
	Mn-54 (Approx. 310 days)	ND	ND	ND	0.29 [12/6]	0.94 <1/8>	ND	ND	ND	ND	0.54 [10/30]	-
	Co-60 (Approx. 5 years)	ND	ND	ND	ND	ND	ND	ND	ND	ND	ND	-
	Sb-125 (Approx. 3 years)	ND	ND	ND	ND	26 [9/29]	ND	ND	ND	1.6 <1/1>	ND	ND
Gross β	1,700 [7/8]	380 [7/29]	530 [12/29]	1,500 [12/6]	46,000 [9/29]	3,200 [12/5]	270 [12/20]	240,000 [12/12]	1,400 [7/11]	180 [8/1]	ND	43 [12/18]
H-3 (Approx. 12 years)	870 [12/8]	440 [8/26]	660 <1/8>	1,700 [12/6]	6,300 [12/4]	1,200 [11/24] [11/27]	1,000 [11/21] [12/4]	5,100 [12/6]	3,200 [2012/12] [12/4]	460 [8/1]	170 [9/18]	170 <1/8>
Sr-90(Approx. 29 years)	54 [5/31]	Under analysis	Under analysis	Under analysis	Under analysis	Under analysis	Under analysis	-	8.3 [2012/12] [12]	Under analysis	Under analysis	-

● Since some samples are still under analysis, the highest dose of the Strontium-90 is among those previously announced.

\*1 The analysis result of No.2-5 obtained on September 29 is the reference value, since we could not sample groundwater by a regular procedure.

\*2 Analysis result of pumped water.

\* "ND" indicates that the measurement result is below the detection limit.

\* Date of sampling is provided in parentheses.

\* "" is provided next to the name of the holes where the sampling could not be performed due to the chemical injection of ground improvement.

<Reference> The Highest Dose Until the Previous Measurement\* (Seawater)

Unit: Bq/L

	1F, North side of Unit 5,6 discharge channel	1F, In front of Unit 6 water intake channel	1F, In front of shallow draft quay	1F, North side of Unit 1-4 water intake channel	1F, North side of Unit 1-4 water intake channel (north side of East Seawall Break)	1F, Unit 1 Screen (Inside the Silt Fence)	1F, Between the water intake channel of Unit 1 and Unit 2 (surface layer)	1F, Between the water intake channel of Unit 1 and Unit 2 (lower layer)	1F, Unit 2 Screen (Inside the Silt Fence)	1F, Between the water intake channel of Unit 2 and Unit 3	1F, Unit 3 Screen (Inside the Silt Fence)	1F, Between the water intake channel of Unit 3 and Unit 4
Cs-134(Approx. 2 years)	1.8 [6/21]	2.8 [12/2]	5.3 [8/5]	89 [10/10]	32 [10/11]	73 [10/10]	87 [10/10]	93 [10/10]	370 [10/9]	52 [12/21]	350 [7/15]	28 [9/16]
Cs-137(Approx.30 years)	3.3 [6/26]	5.8 [12/2]	8.6 [8/5]	190 [10/10]	73 [10/11]	170 [10/10]	200 [10/10]	200 [10/10]	830 [10/9]	110 [10/11] [12/21]	770 [7/15]	53 [12/16]
Gross β	17 <1/6>	46 [8/19]	40 [7/3]	1,400 [11/7]	320 [8/12]	740 [10/28]	1,200 [12/8]	450 [7/16]	1,700 [10/9]	480 [10/7]	1,000 [7/15]	390 [8/12]
H-3 (Approx. 12 years)	8.6 [6/26]	24 [8/19]	340 [6/26]	4,800 [11/7]	510 [9/2]	2,800 [10/28]	2,800 [12/8]	1,600 [9/1]	2,100 [10/28]	1,200 [10/7]	410 [9/2]	650 [8/12]
Sr-90(Approx. 29 years)	5.8 [6/26] <sup>*1</sup>	—	7.4 [6/26] <sup>*1</sup>	720 [9/22]	220 [8/19]	480 [10/14]	480 [8/22]	290 [10/20]	430 [10/14]	340 [10/14]	120 [9/23]	190 [9/23]

Unit: Bq/L

	1F, Unit 4 Screen (Inside the Silt Fence)	1F, Around the south discharge channel	1F, Port entrance	1F, East side in the port	1F, West side in the port	1F, North side in the port	1F, South side in the port	North side of the north breakwater	Northeast side of the port entrance	East side of the south breakwater	Southeast side of the north breakwater	South side of the south breakwater
Cs-134(Approx. 2 years)	62 [9/16]	ND	3.3 [12/24]	3.3 [10/17]	4.4 [12/24]	5.0 [12/2]	3.5 [10/17]	ND	ND	ND	ND	ND
Cs-137(Approx.30 years)	140 [9/16]	3.0 [7/15]	7.3 [10/11]	9.0 [10/17]	10 [12/24]	8.4 [12/2]	7.8 [10/17]	ND	ND	1.6 [10/18]	ND	ND
Gross β	360 [10/7]	15 <1/13>	69 [8/19]	74 [8/19]	60 [7/4]	69 [8/19]	79 [8/19]	ND	ND	ND	ND	ND
H-3 (Approx. 12 years)	400 [8/12] [10/7]	1.9 [11/25]	68 [8/19]	67 [8/19]	59 [8/19]	52 [8/19]	60 [8/19]	4.7 [8/14]	ND	6.4 [10/8]	ND	ND
Sr-90(Approx. 29 years)	130 [9/23]	0.36 [6/26] <sup>*1</sup>	49 [8/19]	—	—	—	—	—	—	—	—	—

\* The highest result announced in "Detailed Analysis Results in the Port of Fukushima Daiichi NPS, around Discharge Channel and Bank Protection" or the other handouts is provided.

As for "1F, North side of Unit 1-4 water intake channel", the data is obtained since January 14, 2013. For the other locations, the data is obtained since June 14.

● Since some samples are still under analysis, the highest dose of the Strontium-90 is among those previously announced.

\*1 Since reanalysis is ongoing, the figures are just for a reference.

\* "ND" indicates that the measurement result is below the detection limit.

\* Date of sampling is provided in parentheses.

\* "-" indicates that the measurement was out of range.

[Reference] Standard values

Unit: Bq/L

	Cs-134	Cs-137	H-3	Sr-90
Density Limit Specified by the Rule for the Installation, Operation, etc. of Commercial Nuclear Power Reactors (the density limit in the water outside the surrounding monitored areas is provided in section 6 of Appendix 2)	60	90	60,000	30
WHO Guidelines for drinking-water quality	10	10	10,000	10